

HOPO

HOPO[®]

All man's dignity lies in thought

HOPE Group Technology Company LTD.
HOPO China R&D Center, Shenzhen

Tel:
(+86)755 86610062
(+86)755 86610182

Fax:
(+86)755 86611663
[Http://www.hopo.us](http://www.hopo.us)
[Http://www.hopo.com.cn](http://www.hopo.com.cn)
E-mail:sales@hopo.us

**Hardware specification
for profiles with C groove (15-20mm)**



HOPO Public Wechat



HOPO website

HOPO[®]

All man's dignity lies in thought

The nature of family's nobility is happiness

The greatness of love is honesty

The success of career comes from sharing

Dream can be realized only with insistence

The nature of family's nobility is happiness

"Papa.....", "Wangwang...", "Papa..." Mr. HOPO comes back from work. The noise with full of happiness will excite you from your inner mind.





Starting from normal sliding windows and doors solutions, including roller carriages, locking systems and handles, our product range has been expanded to all kinds of window and patio door fitting systems, as well as electric ventilators and RWA system (smoke and heat extraction system with normal ventilation function). Our purpose is to provide systematic solutions for windows and doors fabricators, and curtain wall companies. Highest quality and perfect function to fit various requirements of modern buildings with modern architectural designs is always our target.

Our experience to cooperate with world-wide famous window and door fittings companies improved our quality control system. We are launching products with special galvanizing technology, targeting at environment protection and high anti-rust levels. We even developed complete stainless stain steel (SS304) solutions for tilt-turn windows and transmission gears for wood and PVC windows and doors. Quality, humanization, environment protection are principles for technical research and development which forms the foundation of sustainable development of the company



HOPO in field of solutions for sliding windows and doors (including rollers, gears & handles, MA locks, butterfly locks) is the leading brand in Chinese market and some overseas market. Among the standard window fittings (tilt-turn, casement, top-hung, etc. for aluminum, wood and PVC profiles), HOPO tilt-turn and transmission gears made of stainless steel SS304 is the only one in the world at present, with highest anti-rust property, with ideas of environment protection and Recycling. The designs of HOPO lift-sliding and sliding-folding systems had completed from thorough study of all systems of top-brands in Europe, achieving the final optimized solutions with features of stable usage, easy adjustment and operation, maintenance-free. HOPO patent aluminum sliding folding system, SF65, is very attractive in the market. Ventilator and electric window opening systems have been supplied to the market with years' experience.

HOPO technical service for application including profile design, hardware specifications, drawings for installation and adjustment are key points to ensure perfect function of HOPO fittings. Thorough technical clarification is the basis of all HOPO business.

Contents

Tilt-turn Windows	
ATT50 Tilt-turn Fitting for Aluminum Windows	8 - 9
ATT60 Tilt-turn Fitting for Aluminum Windows	10 - 11
Side-hung Windows	
Solution I	12 - 13
Solution II	14 - 15
Casement Windows	
Casement Windows with C Groove Profiles	16 - 17
Friction Hinges	18 - 19
Side-hung Doors	
Handle-operated Multi-points Lock	20 - 21
Specifications for Swinging Door with C Groove Profiles	22 - 23
Cylinders and Mortise Locks	24 - 25
Double Sides Handles	26 - 27
Passive Leaf	
Specifications for Passive Leaf of Doors (and Windows) with C Groove Profile	28 - 29
Sliding Folding Doors	
Introduction to HOPO Aluminum Sliding Folding Window system SF65	30
Main Fittings of HOPO Slide-folding Door System SF65	31
Specification of Bi-folding Doors	32
Specification for Sliding Folding Doors, Scheme 431	33

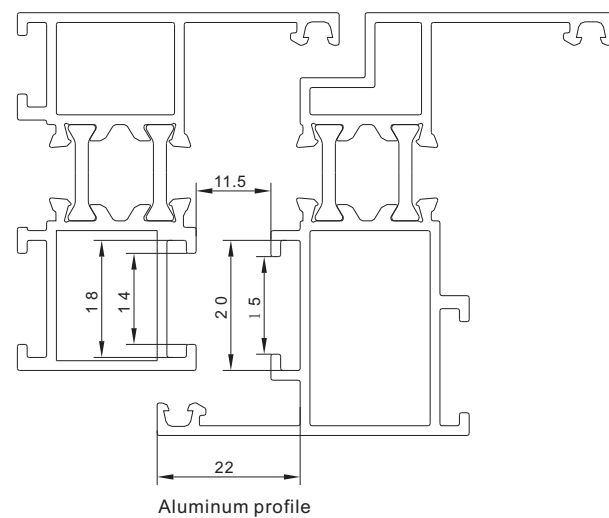

Aluminum profile

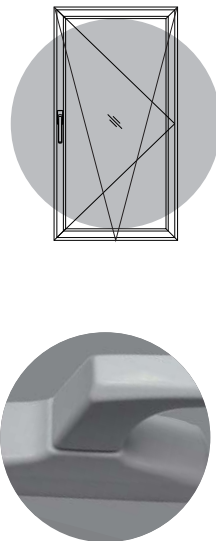

HOPO window fittings for Aluminum Profiles

Profile Dimensions

Sash groove is C type with dimensions of 15mm and 20mm for movement of transmission rod. Frame groove is C type with dimensions of 14mm and 18mm for mounting locking plates and hinges. Groove distance between sash and frame is 11.5mm, and width of overlap is 22mm.

Types of Application

HOPO fittings can be used for single tilt-turn, single inward opening windows, double leaf windows, and casement windows.

Range of Application

ATT50 is a tilt-turn solution for max. width of 900mm, max. weight of 80kg. ATT60 is a tilt-turn solution for max. width of 900mm, max. weight of 90kg, and 130kg with special optional parts.

Adjustments

Hinge parts of ATT50 and ATT60 can be adjusted in 3 dimensions.

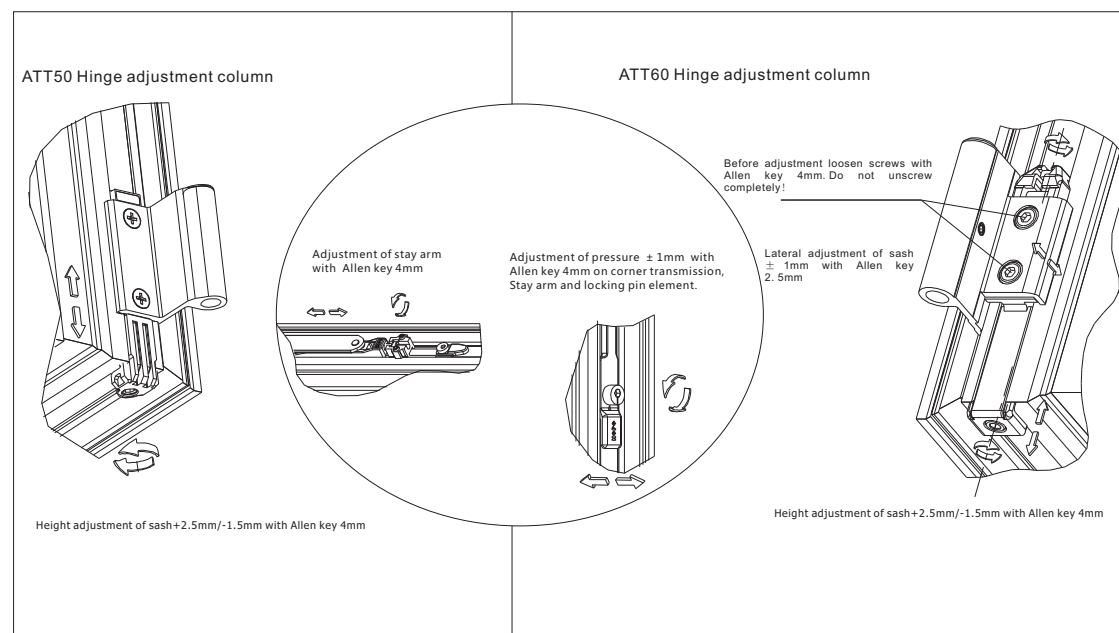

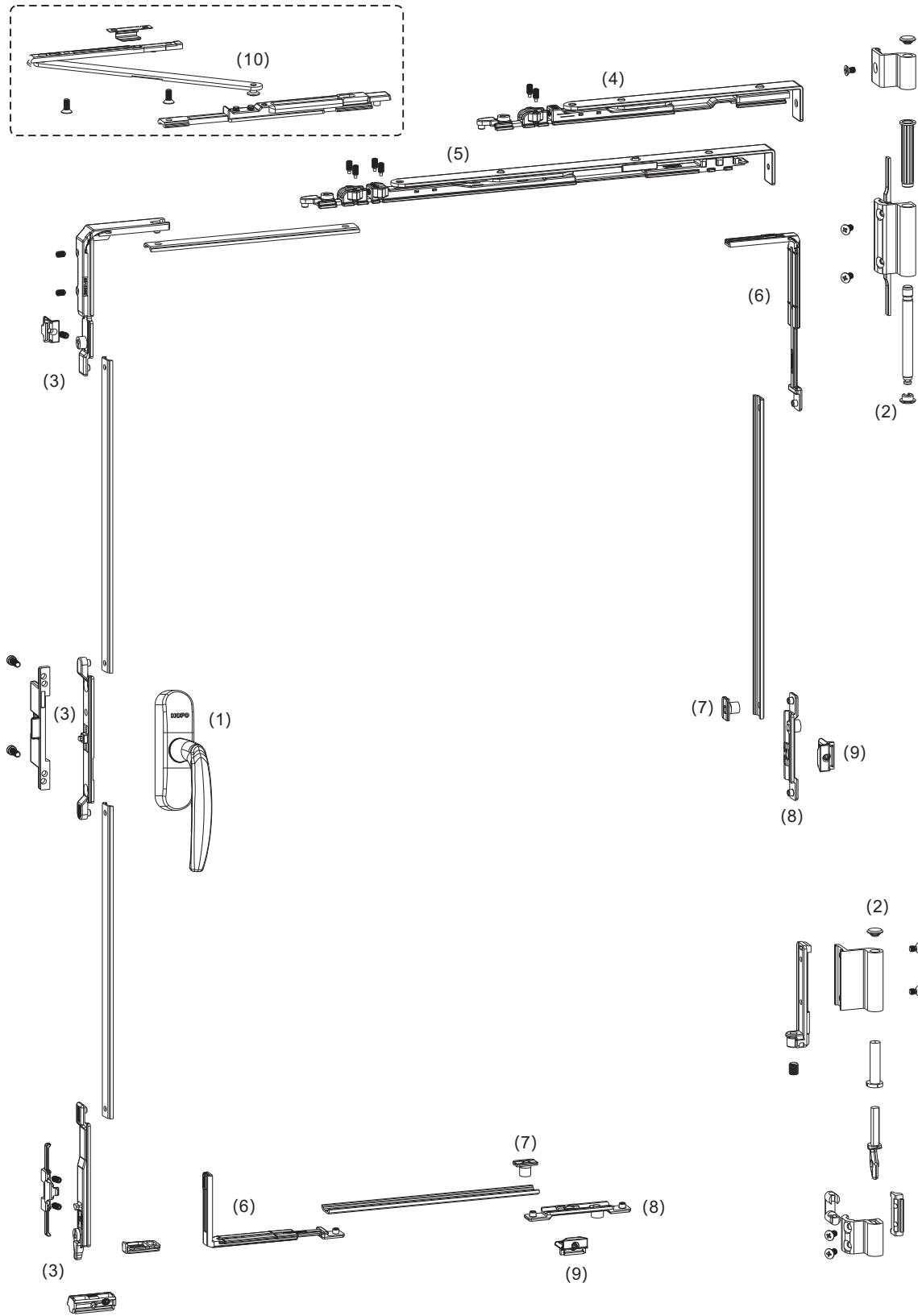

ATT50 Tilt-turn Fitting for Aluminum Windows

Description	Article Number	Unit	Q'ty	Notes
1. Handle	AH606.22.011	pc	1	Anodized silver
2. Hinge Components	AHA50.00.011	set	1	Anodized silver
3. Transmission Components	AD10.00.021	set	1	
4. Stay arm (less than 600mm)	ASA50.30.021	set	1	450-800mm
5. Stay arm (more than 600mm)	ASA50.50.021	set	1	595-1000mm
Option 1: Colors of hinge components				
2. Hinge components	AHA50.00.04	set	1	Anodized bronze
	AHA50.00.07	set	1	Painted white
	AHA50.00.069	set	1	Painted black
Option 2: Colors of handles				
1. Handle	AH606.22.04	pc	1	Anodized bronze
	AH606.22.07	pc	1	Painted white
	AH606.22.069	pc	1	Painted black
Option 3: other optional parts				
6. Corner transmission for middle lock	AMCT10.00.021	pc	1	
7. Locking pin	ALC10.00.021	pc	1	
8. Locking rod	ALR10.00.021	pc	1	
9. Locking plate	ALP10.00.021	pc	1	
10. Additional stay arm	AASA10.00.021	pc	1	

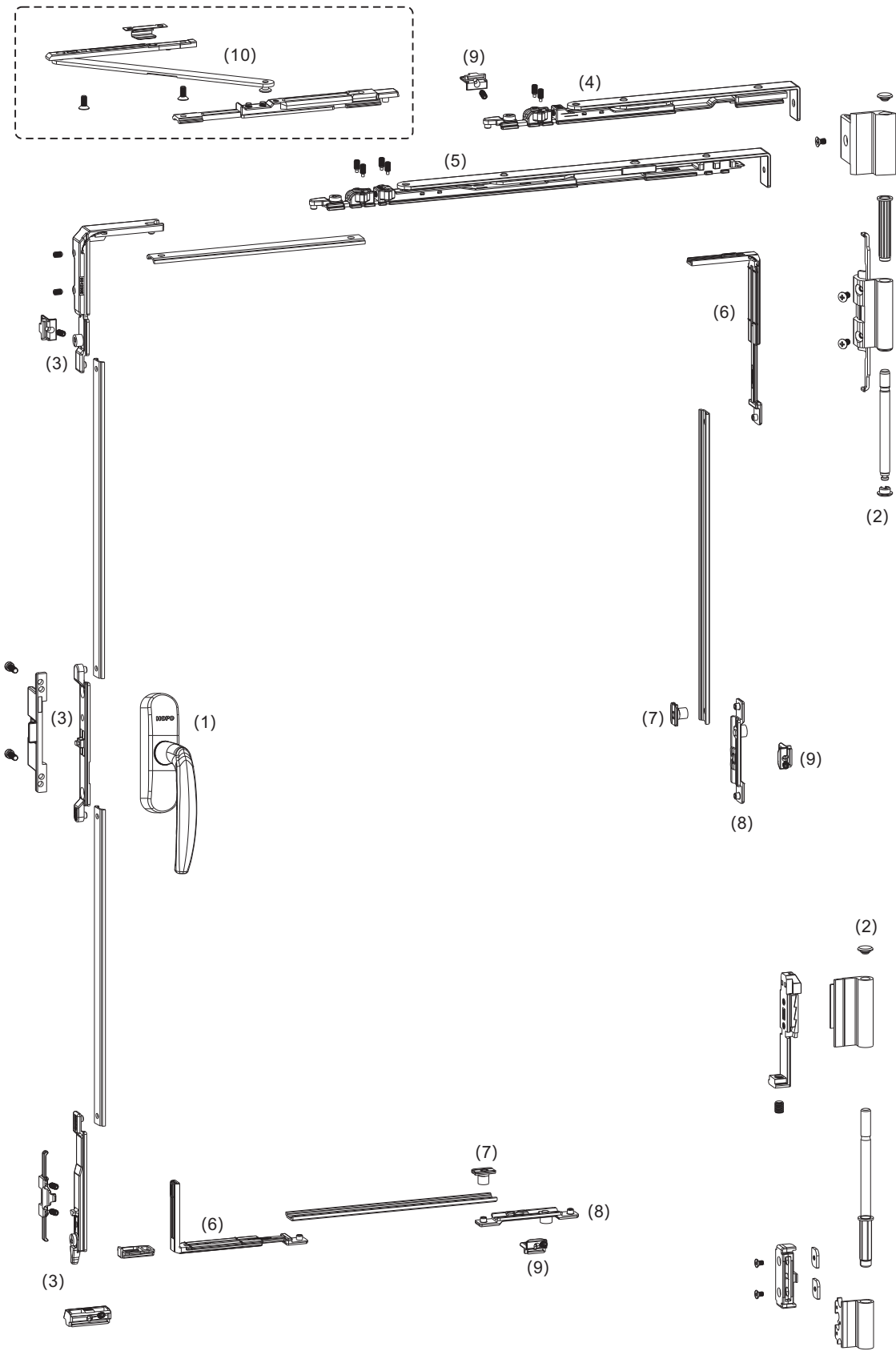

ATT60 Tilt-turn Fitting for Aluminum Windows

Description	Article Number	Unit	Q'ty	Notes
1. Handle	AH606.22.011	pc	1	Anodized silver
2. Hinge Components	AHA60.00.011	set	1	Anodized silver
3. Transmission Components	AD10.00.021	set	1	
4. Stay arm (less than 600mm)	ASA50.30.021	set	1	450-800mm
5. Stay arm (more than 600mm)	ASA50.50.021	set	1	595-1000mm
Option 1: Colors of hinge components				
2. Hinge components	AHA60.00.04	set	1	Anodized bronze
	AHA60.00.07	set	1	Painted white
	AHA60.00.069	set	1	Painted black
Option 2: Colors of handles				
1. Handle	AH606.22.04	pc	1	Anodized bronze
	AH606.22.07	pc	1	Painted white
	AH606.22.069	pc	1	Painted black
Option 3: other optional parts				
6. Corner transmission for middle lock	AMCT10.00.021	pc	1	
7. Locking pin	ALC10.00.021	pc	1	
8. Locking rod	ALR10.00.021	pc	1	
9. Locking plate	ALP10.00.021	pc	1	
10. Additional stay arm	AASA10.00.021	pc	1	

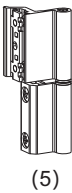
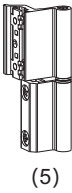
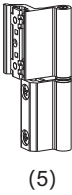
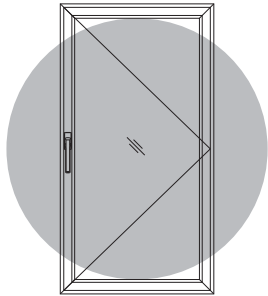
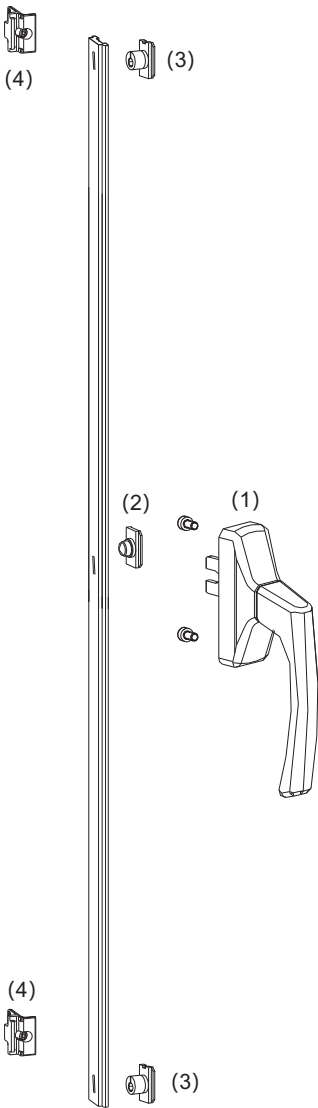

Side Hung Inward Opening Windows

HOPO has two solutions for side hung inward opening windows with different hinges TSH20 and AMH51.

Application range of solution 1 with hinge TSH20: Max. width 900mm, Max. height 2400mm (depends on profiles and number of hinges), Max. weight 60kg.

Application range of solution 1 with hinge AMH51: Max. width 900mm, Max. height 2400mm (depends on profiles and number of hinges), Max. weight 90kg.

Solution I

Description	Article Number	Unit	Q'ty	Notes
1. Handle	AH20.22.07	pc	1	White
2. Transmission part	ATP10.00.021	pc	1	
3. Locking pin	ALC10.00.021	pc	2	
4. Locking plate	ALP10.00.021	pc	2	
5. Hinge (2 wings)	TSH20.07	pc	3	

Note: Colors of painted black, silver, bronze for handle are available.

Note: Opening restrictor refers to next page.

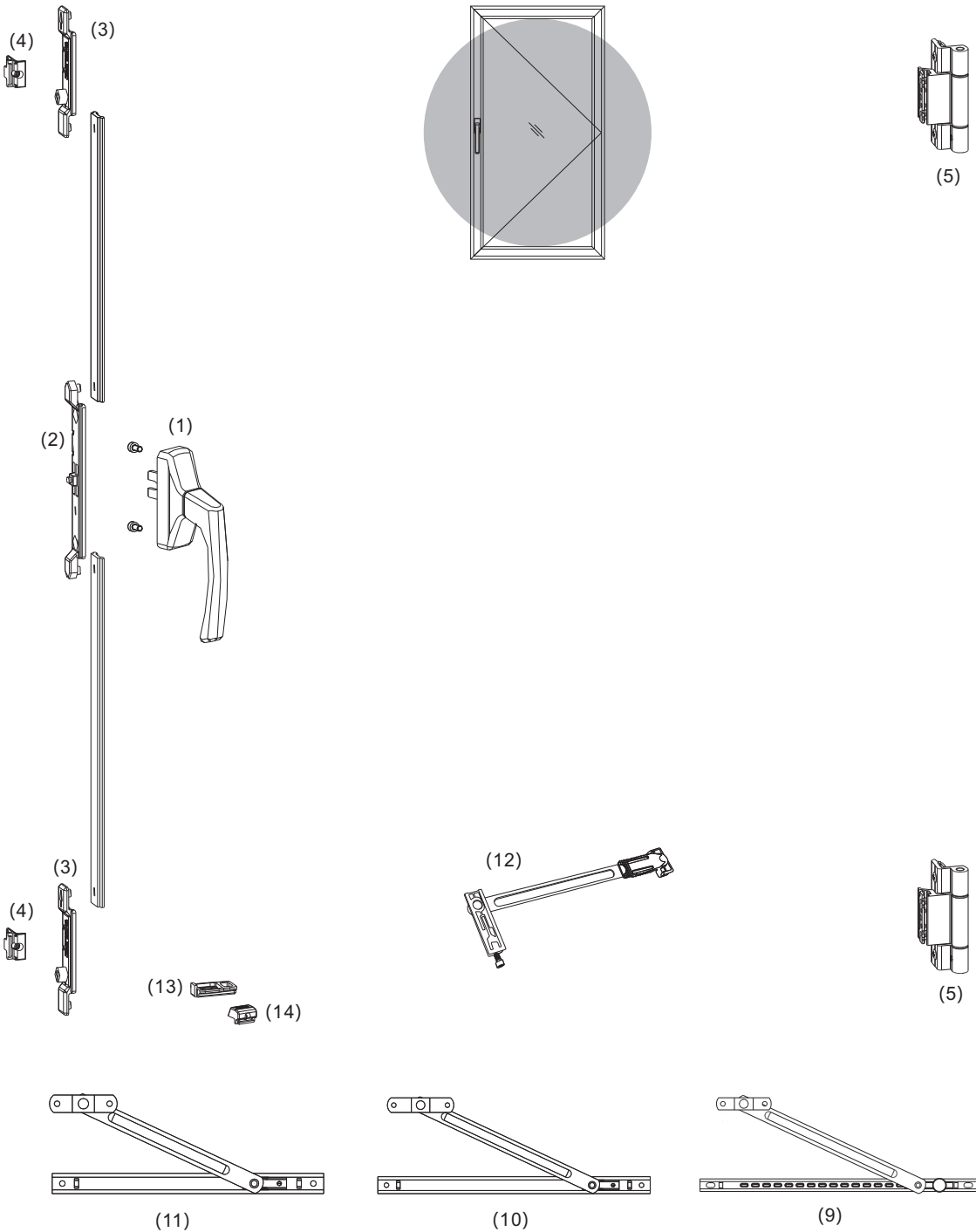

Solution II

Description	Article Number	Unit	Q'ty	Notes
1. Handle	AH20.22.07	pc	1	White
2. Transmission part	APT10.00.021	pc	1	
3. Locking pin	ALR10.00.021	pc	2	
4. Locking plate	ALP10.00.021	pc	2	
5. Hinge (3 wings)	AMH51.07	pc	2	
Optional parts				
9. Opening restrictor Width of base: 13.5mm	TR14.13.16.08C38	pc	1	SS304, Overlay height 16.5mm, length 08"
	TR14.13.16.10C38			SS304, Overlay height 16.5mm, length 10"
	TR14.13.16.12C38			SS304, Overlay height 16.5mm, length 12"
10. Opening restrictor* Width of base: 18.5mm	TR16.18.13.08C38	pc	1	SS304, Overlay height 13.5mm, length 08"
	TR16.18.13.10C38			SS304, Overlay height 13.5mm, length 10"
	TR16.18.13.12C38			SS304, Overlay height 13.5mm, length 12"
	TR16.18.16.08C38			SS304, Overlay height 16.5mm, length 08"
	TR16.18.16.10C38			SS304, Overlay height 16.5mm, length 10"
	TR16.18.16.12C38			SS304, Overlay height 16.5mm, length 12"
11. Opening restrictor* Width of base: 22.5mm	TR18.22.16.08C38	pc	1	SS304, Overlay height 16.5mm, length 08"
	TR18.22.16.10C38			SS304, Overlay height 16.5mm, length 10"
	TR18.22.16.12C38			SS304, Overlay height 16.5mm, length 12"
12. Opening restrictor (C groove mounting, for tilt-turn windows)	ATR20.10C38	pc	1	C groove mounting, SS304, length 10"
	ATR20.12C38			C groove mounting, SS304, length 12"
13. Anti-sink block	AAS10.00.01	pc	1	
14. Supporting block on frame	AFS10.00.01	pc	1	

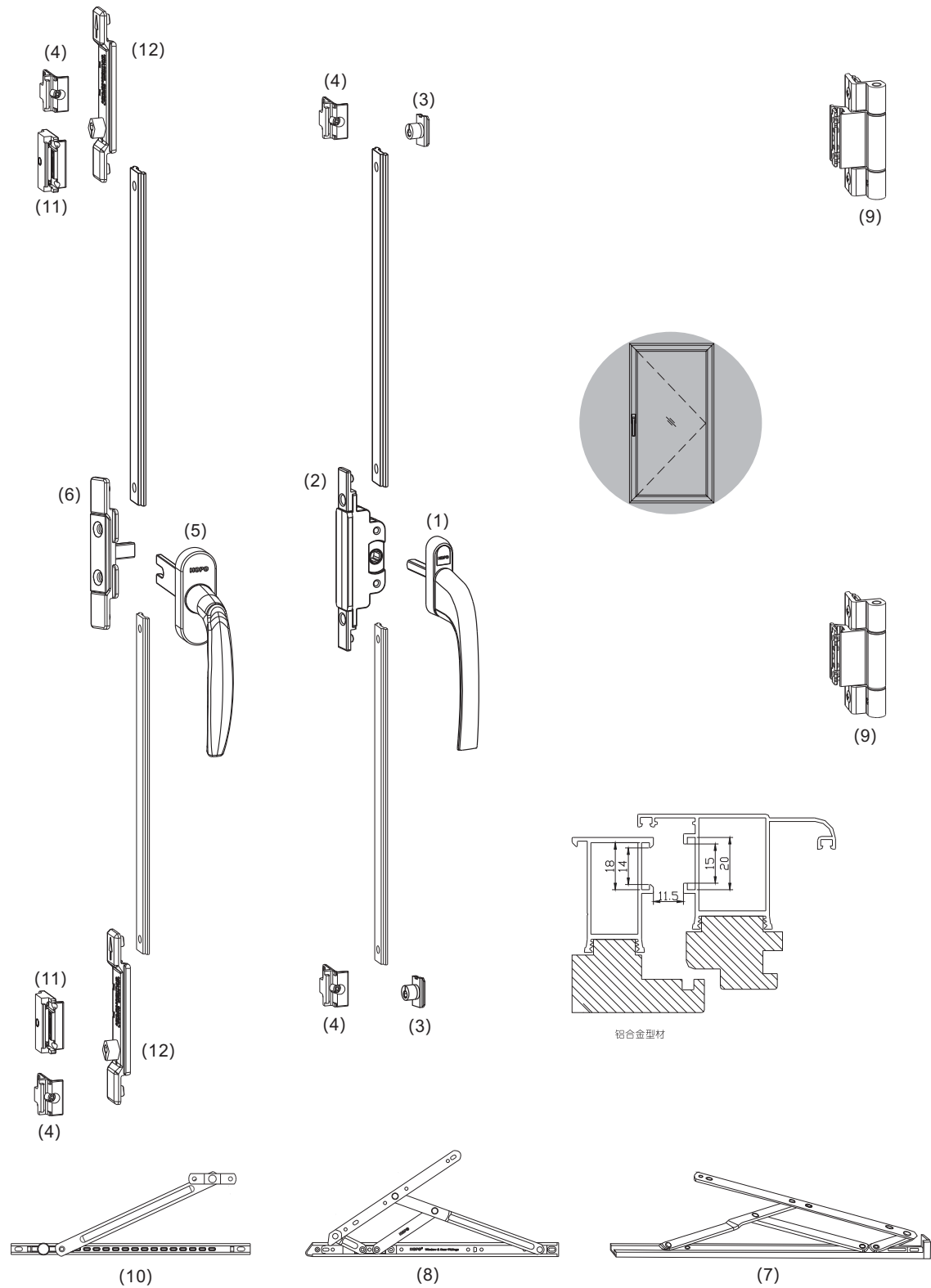

Casement Windows with C Groove Profiles

	Description	Article Number	Unit	Q'ty	Notes
Locking solution 1 handle with square spindle	1. Handle	PH310.40.07	pc	1	White
	2. Gear box	AGC30.23.012	pc	1	Double direction, backset 23mm
		AGC30.30.012			Double direction, backset 30mm
	3. Locking rod	ALC10.00.021	pc	2	
	4. Locking plate	ALP10.00.021	pc	2	
Locking solution 2 Handle with fork	5. Handle	AH35.40.07	pc	1	White
	6. T-type connector	TTC31.19.069	pc	1	
	3. Locking pin	ALC10.00.021	pc	2	
	4. Locking plate	ALP10.00.021	pc	2	
Hinge solution 1 Friction hinge	7. Heavy duty friction hinge Width of base: 22mm	HFH22.16.10C38	pair	1	
		HFH22.16.12C38			
		HFH22.16.14C38			
		HFH22.16.16C38			
		HFH22.16.18C38			
		HFH22.16.20C38			
	8. Heavy duty friction hinge Width of base: 22mm	FH01.2216.10C38	pair	1	
		FH01.2216.12C38			
		FH01.2216.14C38			
		FH01.2216.16C38			
		FH01.2216.18C38			
		FH01.2216.20C38			
Hinge solution 2 Hinge (3 swings)	9. Hinge (3 wings)	AMH51.07	pc	2 ~ 3	
	10. Opening restrictor Width of base: 13.5mm	TR14.13.16.08C38	pc	1	SS304, Overlay height 16.5mm, length 8"
		TR14.13.16.10C38			SS304, Overlay height 16.5mm, length 10"
		TR14.13.16.12C38			SS304, Overlay height 16.5mm, length 12"
Option					
	11. Adjustable locking plate	AALP10.021	pc	2	
	12. Locking rod, 6.5mm	ALR10.021	pc	2	





Friction hinge

3 kinds of friction hinges with overlay heights of 13.5mm, 16.5mm and 17mm can be chosen for different profiles and different load. HOPO friction hinges are made of stainless steel SS304.

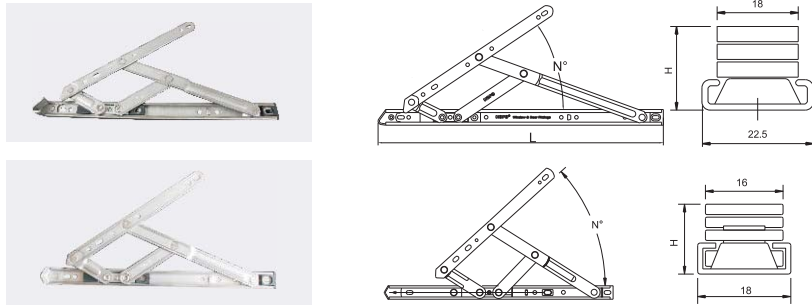

Technical Specifications of Standard Friction hinges

Length(in)	Open Angle	Overlay height	Max. Vent weight	Steel plate thickness	Article number
08"	87°	13.5mm	12kg	2.0mm	SFH18.13.08C38
10"	87°	13.5mm	16kg	2.0mm	SFH18.13.10C38
12"	64°	13.5mm	22kg	2.0mm	SFH18.13.12C38
14"	55°	13.5mm	22kg	2.0mm	SFH18.13.14C38
16"	55°	13.5mm	24kg	2.0mm	SFH18.13.16C38
08"	87°	16.5mm	16kg	2.5mm	SFH18.16.08C38
10"	87°	16.5mm	22kg	2.5mm	SFH18.16.10C38
12"	64°	16.5mm	25kg	2.5mm	SFH18.16.12C38
14"	55°	16.5mm	30kg	2.5mm	SFH18.16.14C38
16"	55°	16.5mm	32kg	2.5mm	SFH18.16.16C38

Technical Specifications of Enhanced Friction hinges

Length(in)	Open Angle	Overlay height	Max. Vent weight	Steel plate thickness	Article number
10"	87°	16.5mm	25kg	2.5mm	HFH22.16.10C38
12"	87°	16.5mm	30kg	2.5mm	HFH22.16.12C38
14"	87°	16.5mm	32kg	2.5mm	HFH22.16.14C38
16"	87°	16.5mm	35kg	2.5mm	HFH22.16.16C38
18"	87°	16.5mm	38kg	2.5mm	HFH22.16.18C38
20"	87°	16.5mm	41kg	2.5mm	HFH22.16.20C38
22"	55°	16.5mm	48kg	2.5mm	HFH22.16.22C38

Technical Specifications of Heavy Duty Friction hinges

Length(in)	Open Angle	Overlay height	Max. Vent weight	Steel plate thickness	Article number
10"	87°	17mm	30kg	3.0mm	FH01.2216.10C38
12"	87°	17mm	35kg	3.0mm	FH01.2216.12C38
14"	87°	17mm	38kg	3.0mm	FH01.2216.14C38
16"	87°	17mm	40kg	3.0mm	FH01.2216.16C38
18"	87°	17mm	43kg	3.0mm	FH01.2216.18C38
20"	87°	17mm	46kg	3.0mm	FH01.2216.20C38
22"	55°	17mm	53kg	3.0mm	FH01.2216.22C38
22"	55°	17mm	56kg	3.0mm	FH01.2216.24C38

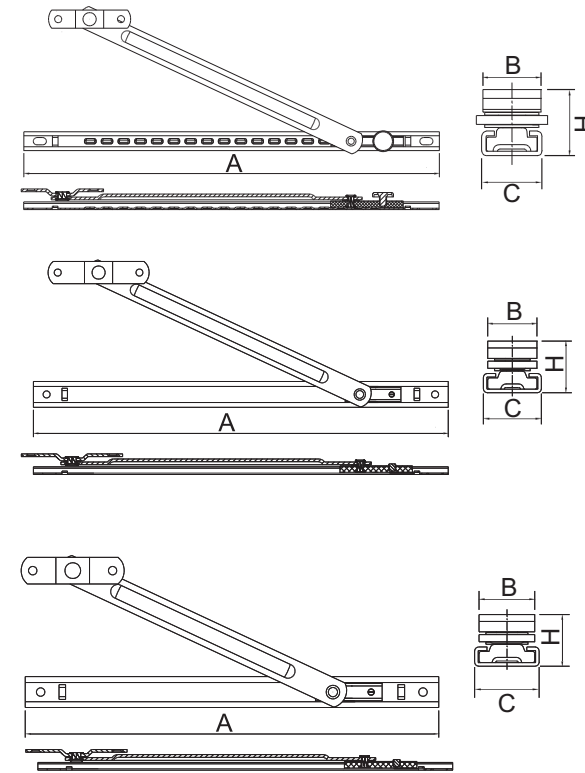

Article No.	Data	A	B	C	H
TR14.13.16.08C38		216	14	13.5	16
TR14.13.16.10C38		268	14	13.5	16
TR14.13.16.12C38		298	14	13.5	16

Article No.	Data	A	B	C	H
TR16.18.13.08C38		216	16	18.5	13.5
TR16.18.13.10C38		268	16	18.5	13.5
TR16.18.13.12C38		298	16	18.5	13.5
TR16.18.16.08C38		216	16	18.5	16.5
TR16.18.16.10C38		268	16	18.5	16.5
TR16.18.16.12C38		298	16	18.5	16.5

Article No.	Data	A	B	C	H
TR18.22.16.08C38		216	18	22.5	16.5
TR18.22.16.10C38		268	18	22.5	16.5
TR18.22.16.12C38		298	18	22.5	16.5

Opening restricter

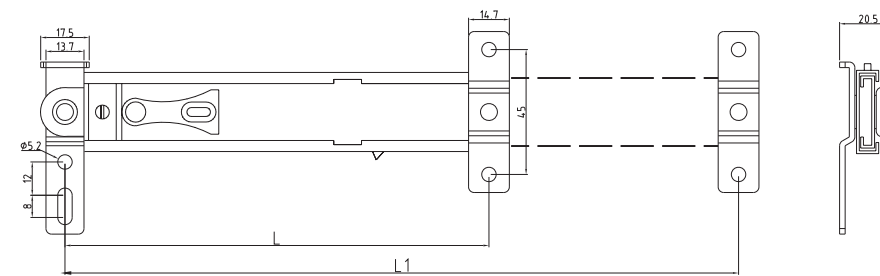

Size	Closing Length	Extending length	Article Number
06	158	208	SS12.06C38
08	207	306	SS12.08C38
10	258	408	SS12.10C38
12	308	508	SS12.12C38

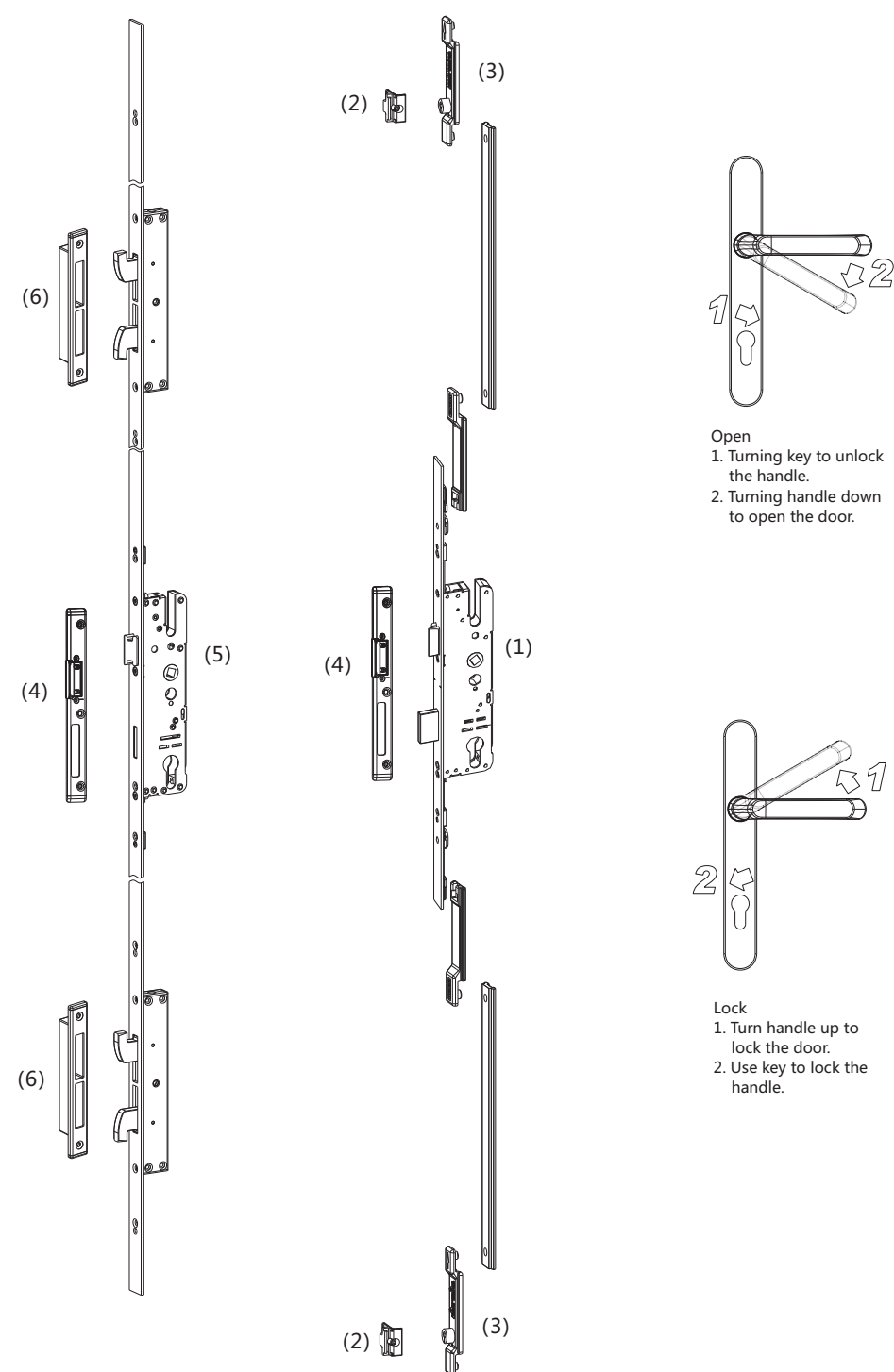

Handle-operated Multi-points Lock

The handle-operated multi-points Lock is suitable for doors in balcony, passageway, and entrance.
Multi-points locking mechanism increases level of security and sealing effect.
To lock or unlock the door with handle, to lock or unlock the handle with key.

Items	Description	Article Number	Backset/Center distance	Width fo Dead-bolt	Square Spindle
1	Lock	SDLH51.33.20C	33mm/92		
		SDLH51.26.20C	26mm/92	20mm	8*8mm
2	Locking plate	ALP10.00.021		20mm	8*8mm
3	Locking rod	ALR10.00.021			
4	Door locking plate	ALPD50.05.021L/R			
5	Lock	SDLH53.33.23C	33mm/92		
6	Bi-forks locking plate	LPD50.01.38		23mm	8*8mm

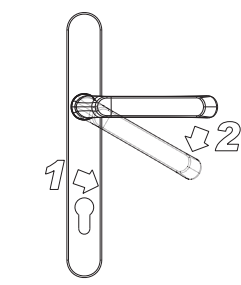

Open
1. Turning key to unlock the handle.
2. Turning handle down to open the door.

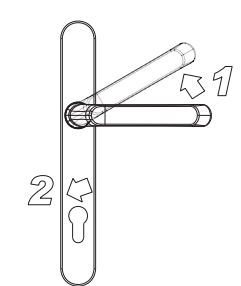

Lock
1. Turn handle up to lock the door.
2. Use key to lock the handle.



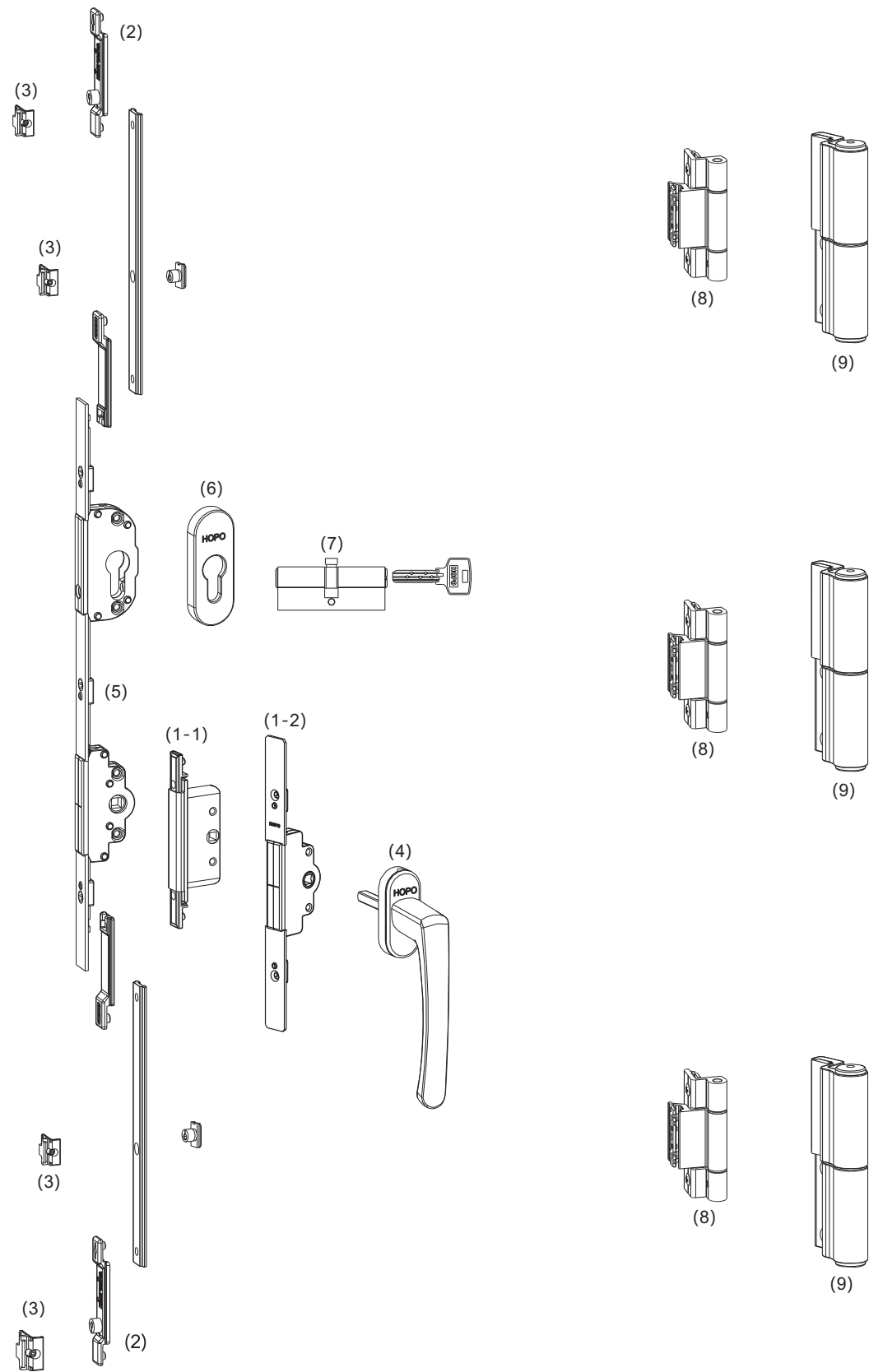

Specifications for swinging Door with C groove profiles

	Description	Article Number	Unit	Q'ty	Notes
Locking solution I Without cylinder	1-1. Gear box	AGC30.30.012	pc	1	2-directionins, BS 30mm
	1-2. Gear box	AGC50.28.021	pc	1	1-directioin, BS 28mm
		AGC50.33.021			1-directioin, BS 33mm
		AGC50.43.021			1-directioin, BS 43mm
	2. Locking rod	ALR10.00.021	pc	2`3	
Locking solution II With cylinder	3. Locking plate	ALP10.00.021	pc	2`3	
	4. Handle	PH100.35.07	pc	1	
	5. Gear with cylinder	AGC51.23.021	pc	1	1-directioin, BS 30mm
		AGC51.28.021			1-directioin, BS 28mm
		AGC51.33.021			1-directioin, BS 33mm
		AGC51.43.021			1-directioin, BS 43mm
	4. Handle	PH100.00.07	set	1	White
		PH101.00.07			
Hinge Solution I	Square spindle	SP7.102	pc	1	(7*7)102mm
	Screw	SC5. 01. 75	pc	2	M5*75
Hinge Solution II	6. Cylinder rosette	CC50.0707	set	1	White (in-outside)
	7. Cylinder	C98.4040C029	pc	1	
Hinge Solution I	8. Hinge (3 wings)	AMH51.011	pc	2`3	70`90kg
Hinge Solution II	9. Barrel hinge	ABH50.00.012	pc	2`3	120`150kg





Cylinders

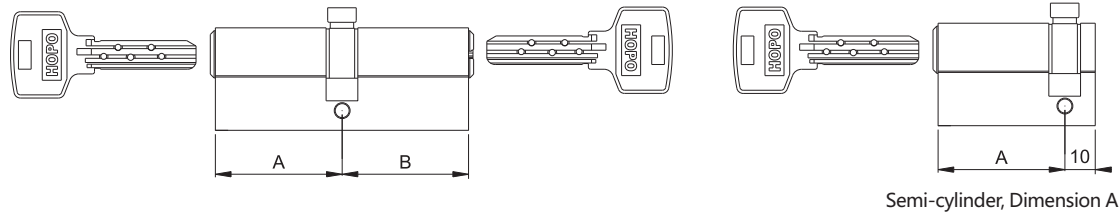

Double-sides Cylinder, Article No. C98. A B C029. Available dimension of A and B:

Dimension A	Dimension B	Notes
	00	Semi-cylinder
25	25	Normal
30	30	Normal
35	35	Normal
40	40	Normal
45	45	Normal
50	50	Normal
55	55	Normal



Cylinders with the different A & B dimensions are available upon request.
Example: C98.3045C029 means A=30mm, B=45mm

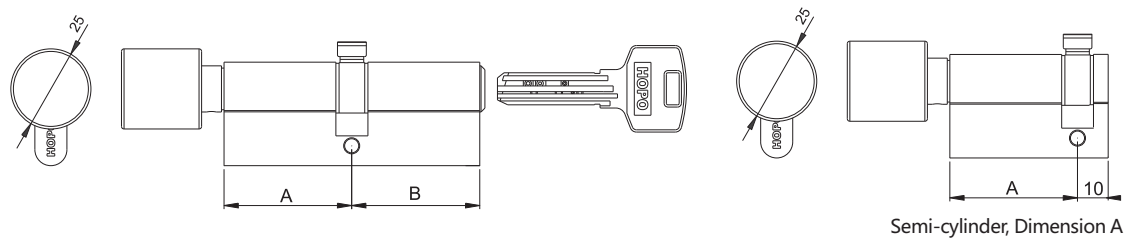

Cylinder with knob (inside), Article No. C99. A B C029. Available dimension of A and B:

Dimension A	Dimension B	Notes
	00	Semi-cylinder
25	25	Normal
30	30	Normal
35	35	Normal
40	40	Normal
45	45	Normal
50	50	Normal
55	55	Normal



Cylinders with the different A & B dimensions are available upon request.
Example: C99.3045C029 means A= 30mm, B=45mm

Mortise Lock

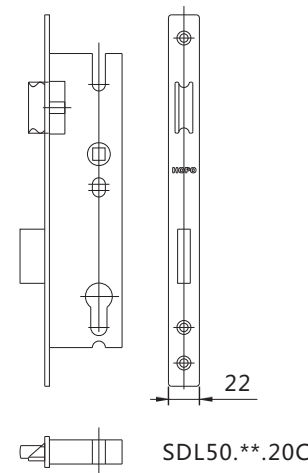

Center distance 92mm, square spindle 8x8mm
Forend 20mm

	Article No.
Backset32mm	SDL50.32.20C38
Backset26mm	SDL50.26.20C38

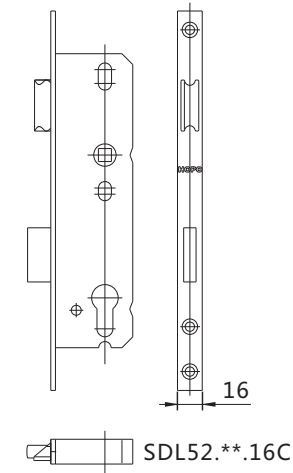

Center distance 92mm, square spindle 8x8mm
Forend 20mm

	Article No.
Backset28mm	SDL52.28.16C38
Backset35mm	SDL52.35.16C38



Double Sides Handle

The narrow front width (28mm) makes it suitable for PVC and aluminum profiles.
For entrance doors, fixed outside handle solution should be chosen.

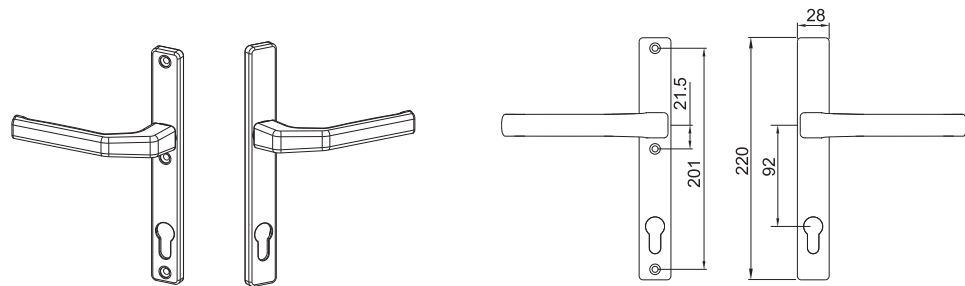

Description	Article Number	Notes
Double-sides Handle	HSD50.0707	White
	HSD50.069069	Black
	HSD50.043043	Bronze (painted)
	HSD50.012012	Silver (painted)

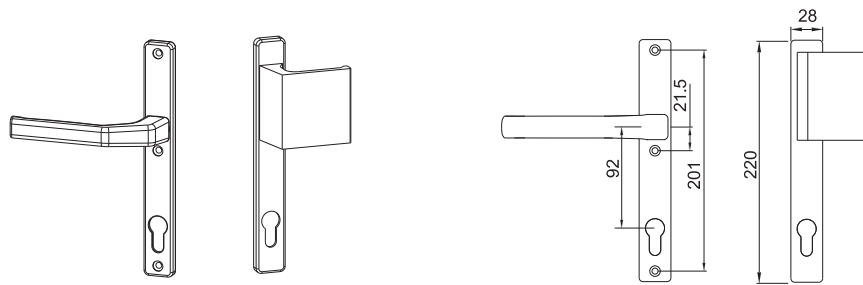

Description	Article Number	Notes
Double-sides Handle	HSD51.0707	White
	HSD51.069069	Black
	HSD51.043043	Bronze (painted)
	HSD51.012012	Silver (painted)

Screws have been hided by the front cover. Width of cover is 32mm.

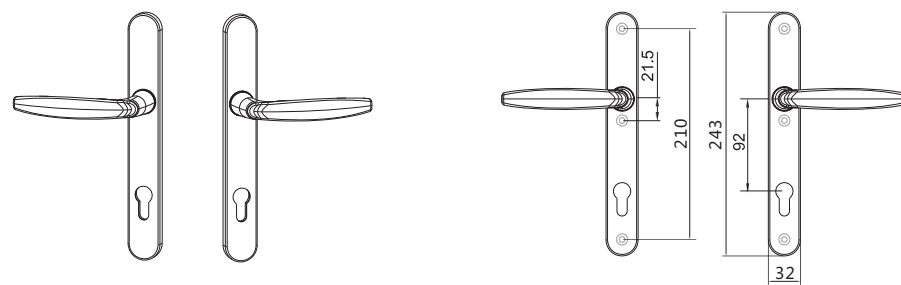

Description	Article Number	Notes
Double-sides Handle	HSD531.0707R/L	White
	HSD531.069069R/L	Black
	HSD531.0404R/L	Bronze (painted)
	HSD531.011011R/L	Silver (painted)

Double-sides Handle with no cylinder hole:HSD541.0707R/L
Handles are fixed, used on passive leaf.

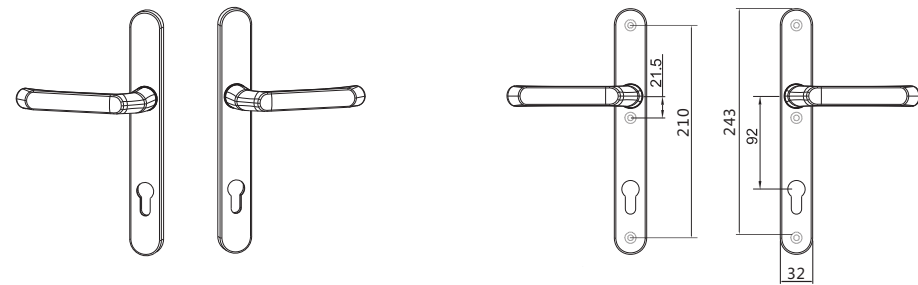

Description	Article Number	Notes
Double-sides Handle	HSD533.0707R/L	White
	HSD533.069069R/L	Black
	HSD533.0404R/L	Bronze (painted)
	HSD533.011011R/L	Silver (painted)

Double-sides Handle with no cylinder hole:HSD543.0707R/L
Handles are fixed, used on passive leaf.



Solution I

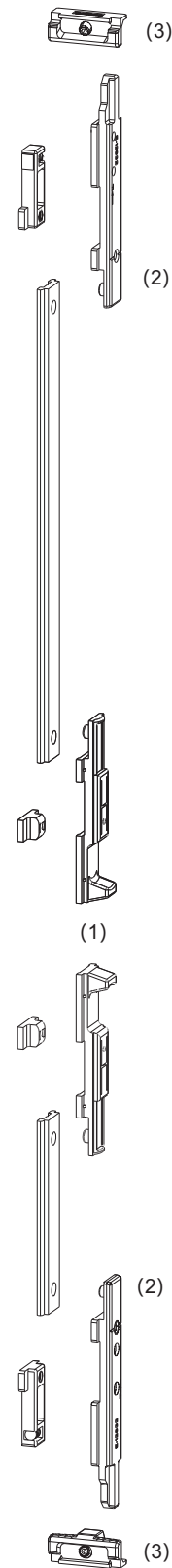

Solution II

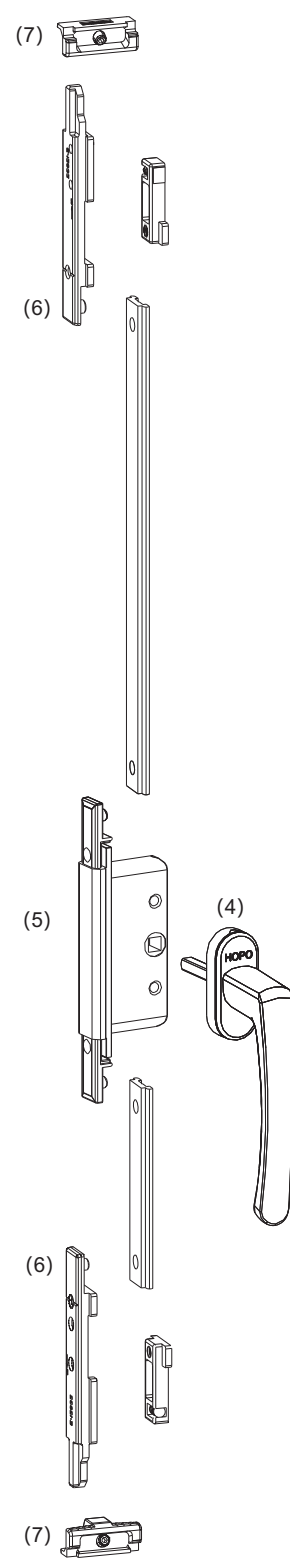

Solution III

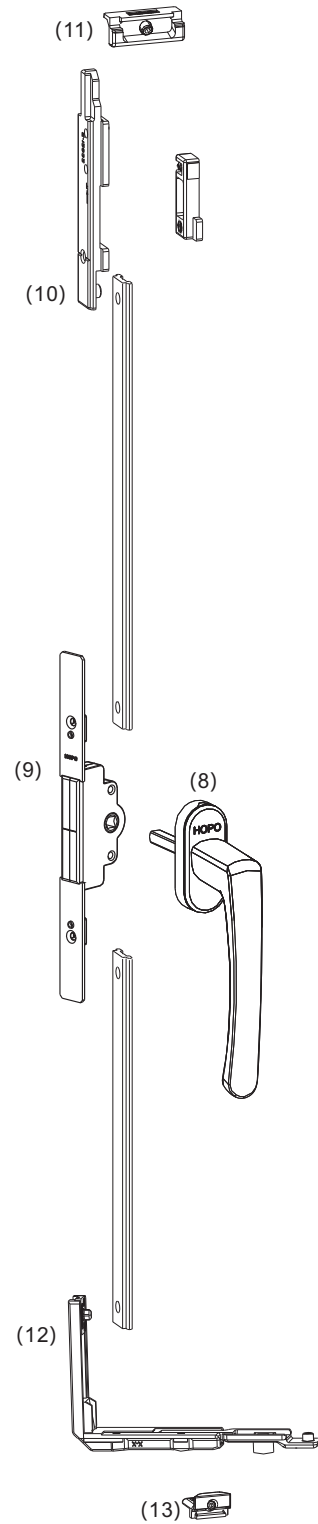

Specifications for Passive Leaf of Doors (and Windows) with C Groove Profile

	Description	Article Number	Unit	Q'ty
Solution I: Grip operated (for movable mullion with C groove)	1. Grip for shoot bolt	ASBH20.00.06	pc	2
	2. Shoot bolt for C groove	ASB20.00.021	pc	2
	3. Shoot bolt for C groove profile	ASLP20.00.021	pc	2
Solution II: Handle + gear box (2 directions)	4. Handle	PH100.35.07	pc	1
	5. 2 directions gear box	AGC30.20.012	pc	1
		AGC30.23.012		
		AGC30.30.012		
	6. Shoot bolt for C groove	ASB20.00.021	pc	2
	7. Shoot locking plate	ASLP20.00.021	pc	2
Solution III: Handle + gear box (1 direction)	8. Handle	PH100.35.07	pc	1
	9. 1 direction gear box	AGC50.28.021	pc	1
		AGC50.33.021		
	10. Shoot bolt for C groove	ASB20.00.021	pc	1
	11. Shoot locking plate	ASLP20.00.021	pc	1
	12. Corner transmission	ACT10.00.021	pc	1
	13. Locking plate	ALP10.00.021	pc	1



HOPO Aluminum Sliding Folding Window system SF65

Patent system solution for profile and fittings ensures easy and fast assembly and installation. Enhanced structure design make the movement of sliding very smoothly.

Patent profile system

With few kinds of profiles, the system can achieve various door types, single-leaf door, double-leaves door, bi-folding door, slide-folding door. The gasket design has the function of anti-crush for fingers. Bottom profile has an embedding stainless steel rod structure as guide rail, to prevent damage to the surface finishing as normal structure and to make the movement of door leaves more smoothly. Fabricators can adjust the profile structure according to the requirements of static calculation and decorative effect.

Patent fitting system

Hinges mounting on grooves of sashes achieves harmonious visual effect. For a finished sliding folding door, changing positions of rollers can change door schemes easily. The end-edge folding solution hides rollers in closing position, while rollers are not visible at any position for bi-folding solution. Clamping-Mounting method of hinges and rollers makes the installation and adjustment very easy with no need of any screw. Roller structure of bottom roller carriage is 4 stainless steel load-bearing rollers and 3 guide rollers. Max. height of the system can reach up to 3000mm (depends on profile). Max. width of each leaf is 900mm with max. weight of 100kg.

Main Fittings of HOPO Slide-folding Door System SF65

1. Box of Rollers ABR65.30.011

The key point to design the roller structure is to overcome the influence of the eccentric load-bearing during the slide-folding movement of door leaves. The top roller carriage has 3 guiding rollers equipped with self-lubricating bearings made by powder metallurgy that is the ideal solution for taking the eccentric load-bearing effect. The bottom roller carriage has 4 stainless steel wheels to take the vertical load of the door leaf and the eccentric load during opening procedure, while the 3 guide rollers on the bottom roller carriage forms the secondary insurance for the eccentric load. The roller carriages has the Clamping-Mounting structure with no need of screwing. Adjustment of rollers are available in 3 dimensions.



2. Folding hinge ASH65.02.011

The folding hinge is made of extruded aluminum profile with anodized silver color. The hinge has the same clamping-mounting structure as the rollers.



3. Handle hinge AHH65.011

The handle hinge is installed on height of 1 meter above ground for easy operation of closing the door leaves.





Specification of Bi-folding Doors

1
Tilt-turn window

2
Side-hung window

3
Casement window

4
Side-hung door

5
Passive Leaf

6
Slide-folding Door

Items	Description	Article Number	Unit	Q'ty
1	Box of rollers	ABR65.20.021	set	2
2	Box of hinge	ASH65.02.011	set	12
3	Gear box	AGC65.14.021	pc	4
4	Handle	PH172.40.028	pc	4
5	Shoot bolt	ASB65.00.06	pc	4

Specification for Sliding Folding Doors, Scheme 431

1
Tilt-turn window

2
Side-hung window

3
Casement window

4
Side-hung door

5
Passive Leaf

6
Slide-folding Door

Items	Description	Article Number	Unit	Q'ty
1	Box of rollers	ABR65.30.011	set	1
2	Box of hinge	ASH65.02.011	set	10
3	Door leaf Catcher	TBL65.06	set	1
4	Gear box	AGC65.14.021	pc	2
5	Handle	PH100.04.011	pc	2
6	Shoot bolt	ASB65.00.06	set	2
7	Double-sides handle	HSD53.028028L/R	pc	1
8	Lock	SDL52.35.16C38	pc	1
9	Cylinder	C98.4545C029	pc	1
10	Door locking plate	ALPD50.03.1T021L/R	pc	1



**Dream can be realized
only with insistence**

The most difficult thing for realizing your idea is
often the first step you realize it.

To arm your dream with bravery,

you will achieve the final target after overcoming
all difficulties.