

HOPO

HOPO[®]

All man's dignity lies in thought

HOPE Group Technology Company LTD.
HOPO China R & D Center, Shenzhen

Tel:
(+86)755 86610062
(+86)755 86610182

Fax:
(+86)755 86611663
[Http://www.hopo.us](http://www.hopo.us)
[Http://www.hopo.com.cn](http://www.hopo.com.cn)
E-mail:sales@hopo.us

Hardware specification for profiles with U groove(16mm)



HOPO Public Wechat



HOPO Website

HOPO[®]

All man's dignity lies in thought

The nature of family's nobility is happiness

The greatness of love is honesty

The success of career comes from sharing

Dream can be realized only with insistence

The nature of family's nobility is happiness

"Papa.....", "Wangwang...", "Papa..." Mr. HOPO comes back from work. The noise with full of happiness will excite you from your inner mind.

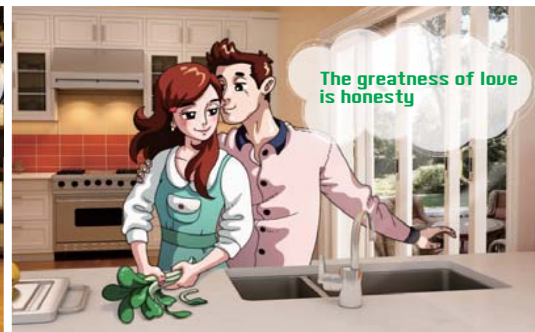



The success of business
comes from sharing

Starting from normal sliding windows and doors solutions, including roller carriages, locking systems and handles, our product range has been expanded to all kinds of window and patio door fitting systems, as well as electric ventilators and RWA system (smoke and heat extraction system with normal ventilation function). Our purpose is to provide systematic solutions for windows and doors fabricators, and curtain wall companies. Highest quality and perfect function to fit various requirements of modern buildings with modern architectural designs is always our target.

Our experience to cooperate with world-wide famous window and door fittings companies improved our quality control system. We are launching products with special galvanizing technology, targeting at environment protection and high anti-rust levels. We even developed complete stainless steel (SS304) solutions for tilt-turn windows and transmission gears for wood and PVC windows and doors. Quality, humanization, environment protection are principles for technical research and development which forms the foundation of sustainable development of the company



HOPO in field of solutions for sliding windows and doors (including rollers, gears & handles, MA locks, butterfly locks) is the leading brand in Chinese market and some overseas market. Among the standard window fittings (tilt-turn, casement, top-hung, etc. for aluminum, wood and PVC profiles), HOPO tilt-turn and transmission gears made of stainless steel SS304 is the only one in the world at present, with highest anti-rust property, with ideas of environment protection and Recycling. The designs of HOPO lift-sliding and sliding-folding systems had completed from thorough study of all systems of top-brands in Europe, achieving the final optimized solutions with features of stable usage, easy adjustment and operation, maintenance-free. HOPO patent aluminum sliding folding system, SF65, is very attractive in the market. Ventilator and electric window opening systems have been supplied to the market with years' experience.

HOPO technical service for application including profile design, hardware specifications, drawings for installation and adjustment are key points to ensure perfect function of HOPO fittings. Thorough technical clarification is the basis of all HOPO business.

Contents

Sliding window and door	
Specification for sliding window and door	6-7
Rollers, Crescent lock	8-9
Lift-sliding door	
Specification for lift-sliding door 150kg	10-11
Specification for lift-sliding door 250kg	12-13
Tilt-turn window	
Specification for tilt-turn windows	16-17
Specification for Alu-wood tilt-turn windows: ATT90	18-19
Side hung window	
Specification for side hung windows	20-21
Casement window	
Specification for casement windows	22-23
Friction hinges	24-25
Side hung door	
Specifications for Single-leaf Doors	26-27
Specification of Handle-operated Multi-points Lock for Single Door	28-29
Cylinders and Mortise locks	30-31
Double Sides Handles	32-33
Hinges	34-35
Passive leaf	
Specification for Passive Solutions	36-37
Sliding folding door	
Specification of HOPO SF60 for PVC profiles	38-41

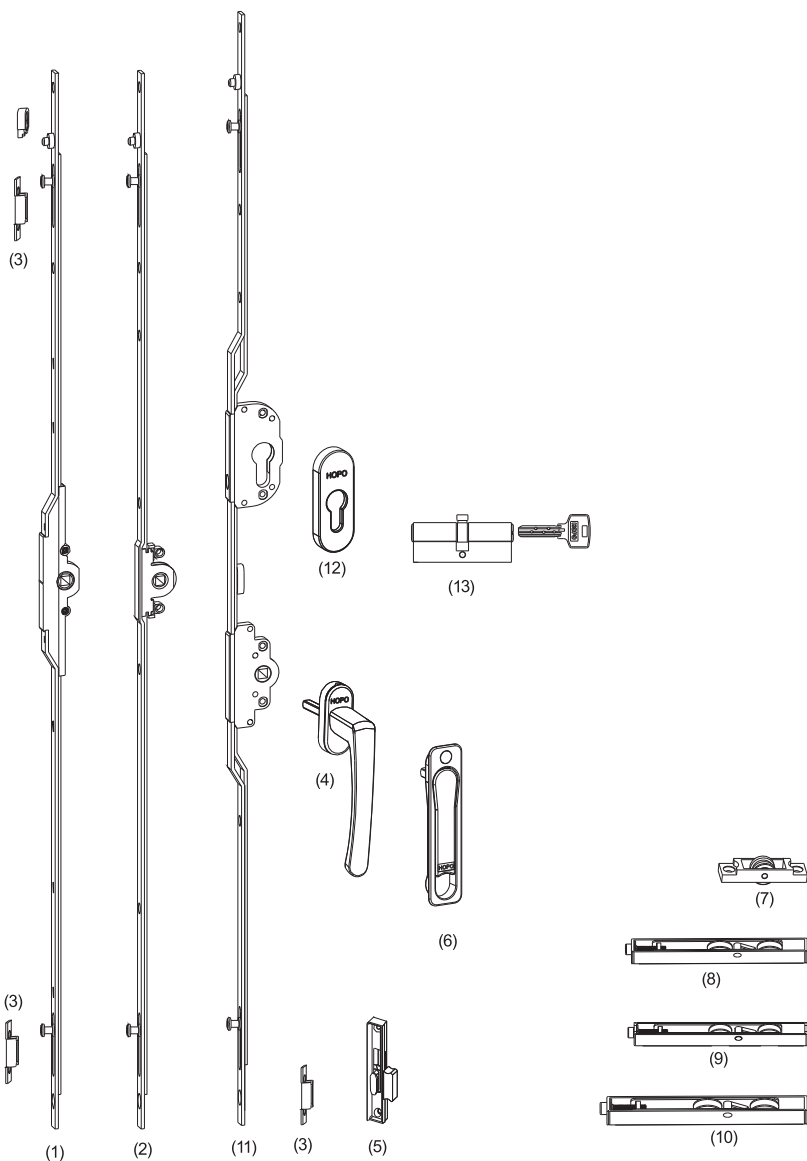

Specification for Sliding Windows and Doors

		Description	Article Number	Unit	Q'ty	Notes
Active leaf	7.5mm Backset	1. Gear transmission	GV40.75.04C021	pc	1	2 mushroom locking pins
			GV40.75.06C021	pc		
			GV40.75.08C021	pc		
			GV40.75.10C021	pc	1	3 mushroom locking pins
			GV40.75.12C021	pc		
			GV40.75.14C021	pc		
	15mm Backset	2. Gear transmission	GV40.75.16C021	pc	1	2 mushroom locking pins
			GV40.15.04C021	pc		
			GV40.15.06C021	pc		
			GV40.15.08C021	pc		3 mushroom locking pins
			GV40.15.10C021	pc		
			GV40.15.12C021	pc		
Passive leaf	Solution 1	3. Locking plate for sliding doors	PLP40.00.021	pc	2~3	According to profiles
		4. Standard handle	PH100.30.07	pc	1	White
		5. Slide fastener	SBL40.00.07	pc	1	
	Solution 2	3. Locking plate for sliding doors	PLP40.00.021	pc	1	
		6. Concealed handle	PH400.20.07	pc	1	According to profiles
		Gear transmission		pc	1	
Rollers for PVC profiles		3. Locking plate for sliding doors	PLP40.00.021	pc	2~3	According to profiles
		7. Single roller carriage	R16.161100.021	pc	2	WEKA/Shide/Conch
		8. Roller for sliding door	R01.122007.021	pc	2	WEKA/Shide/Conch
		Acc.	RPS10.00.07X	pc	2	Koemmerling
		9. Double roller	R12.121805.021	pc	2	WEKA/Shide/Conch
Active leaf with cylinder		10. Heavy duty roller	R02.162807.021	pc	2	Roller mounted on reinforcement
		Cylinder solution: to change fittings of Active leaf with the following:				
		11. Gear transmission with cylinder	GV41.15.16C021	pc	1	2 mushroom locking pins
		3. Locking plate for sliding doors	PLP40.00.021	pc	2	According to profiles
		4. Double-sides handle	PH100.00.07	set	1	White
			PH101.00.07	set	1	White
		Square spindle (7x7) 102mm	SP7.102	pc	1	According to profiles
		Screws	SC5.01.75	pc	2	M5×75
		12. Rosette	CC50.0707	set	1	White
		13. Cylinder	C98.3030C029	pc	1	According to profiles





Roller Carriages

HOPO's rollers cover wide range of application. The following 4 rollers are used for standard PVC profiles. Options are bearing steel or stainless steel for bearings, galvanized steel or stainless steel for the carriages, height adjustable or unadjustable, single roller, double rollers or 4 rollers for the roller structures. Load of roller carriages are 40, 50, 80, 90, 120, 150, 200, 300kg. For detailed information about HOPO roller carriages, please check at web-site: www.hopo.us.



Crescent Lock

We believe that perfect solution comes from combination between mechanical technology and esthetical design. HOPO crescent lock is an example of such creature.

Material: Zinc alloy

Technology: hand shank and rosette are dye-casting; painting finishes; high quality spring steel for the inside spring; stainless steel SS304 for the hook; concealed screw installation.

Color: White, black, or as request

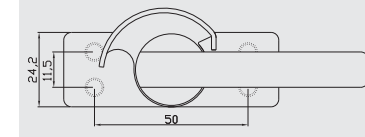
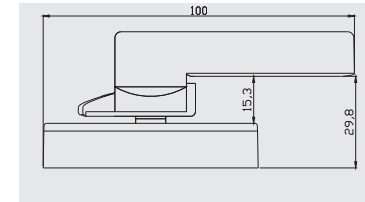
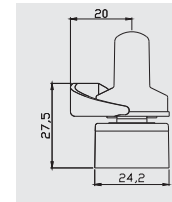

CL437.01.069R

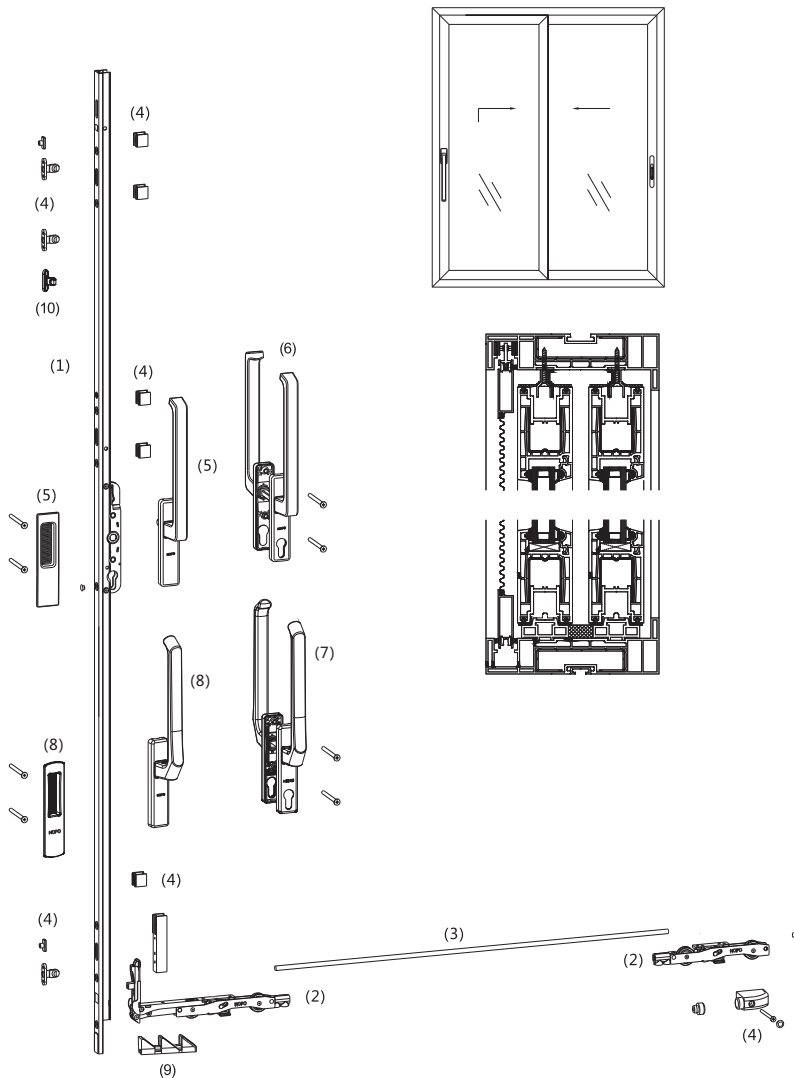

Lift-sliding door fitting (150kg)

Max. weight of sash is 150kg. When turning down the handle, the door leaf drops down, gaskets on top and bottom can achieve perfect sealing effect. The fitting is maintenance free and have a very long life time.

Items	Description	Article Number	Unit	Notes
1	Gear of lift-sliding	LSG715.00.011	pc	
2	Bag of roller carriages	LSBR715.00.015	set	
3	Connecting rod	LSS70.11C38	pc	
	Connecting rod	LSS70.18C38		
	Connecting rod	LSS70.20C38		
4	Bag of accessories	LSAB70.00	bag	
5	Single-side handle + flush pull	SLSH70.00.011	set	without cylinder hole
	Single-side handle + flush pull	SLSH70.01.011		with cylinder hole
6	Double-sides handle	SLSH71.00.011	set	without cylinder hole
	Double-sides handle	SLSH71.01.011		with cylinder hole
7	Double-sides handle	LSHD702.00.011	set	without cylinder hole
	Double-sides handle	LSHD702.01.011		with cylinder hole
8	Single-side handle + flush pull	LSHS702.00.011	set	without cylinder hole
	Single-side handle + flush pull	LSHS702.01.011		with cylinder hole
9	Opening restrictor	LTB70.00.021	pc	
10	Locking plates	LSLP70.01.021	pc	

Note:

The spacers inside the bag of accessories can be ordered with different height dimensions, 25mm, 21mm, 16mm, 13mm.

Items 5 and 8 have the following accessories			
Square spindle (10x10) 100mm	SP10.100	1pc	
Screws	SC6.01.60	2pcs	
Items 6 and 7 contents			
Square spindle (10x10) 100mm	SP10.150	1pc	
Screws	SC6.01.60	2pcs	

Item 4 contents:			
Plastic adaptor	2pcs	M5*16Stainless steel screws	1pc
Plastic cover	2pcs	M5*30Stainless steel screws	1pc
Big spacer	1pc	ST5*20Stainless steel screws	4pcs
Small spacers	5pcs	ST5*40Stainless steel screws	4pcs
Anticollision block	2pcs	ST5*50Stainless steel screws	1pcs
Anti-lifting block	2pcs	ST5*70Stainless steel screws	6pcs
Locking plates	2pcs		

Article number for bag of accessories without locking plates: LSAB70.50.25

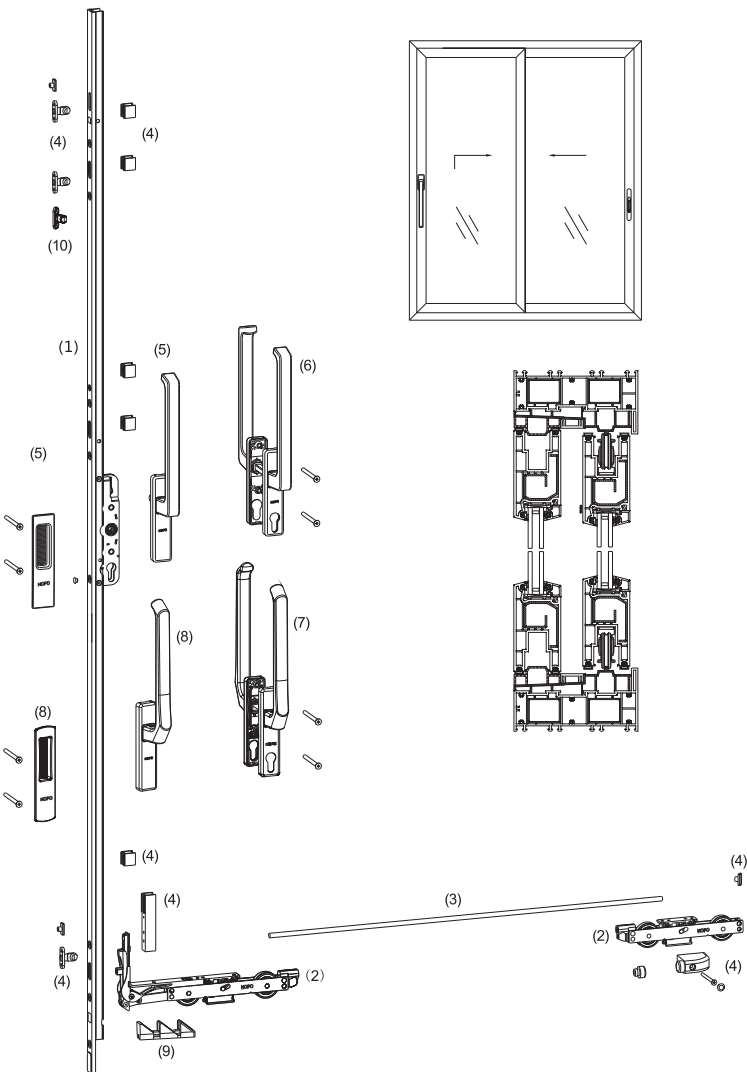

Lift-sliding door fitting (250kg)

Max. weight of sash is 250kg. When turning down the handle, the door leaf drops down, gaskets on top and bottom can achieve perfect sealing effect. The fitting is maintenance free and have a very long life time.

Items	Description	Article Number	Unit	Notes
1	Gear of lift-sliding	LSG725.00.011	pc	
2	Bag of roller carriages	LSBR725.00.015	set	
3	Connecting rod	LSS70.11C38	pc	
	Connecting rod	LSS70.18C38		
	Connecting rod	LSS70.20C38		
4	Bag of accessories	LSAB70.00	bag	
5	Single-side handle + flush pull	SLSH70.00.011	set	without cylinder hole
	Single-side handle + flush pull	SLSH70.01.011		with cylinder hole
6	Double-sides handle	SLSH71.00.011	set	without cylinder hole
	Double-sides handle	SLSH71.01.011		with cylinder hole
7	Double-sides handle	LSHD702.00.011	set	without cylinder hole
	Double-sides handle	LSHD702.01.011		with cylinder hole
8	Single-side handle + flush pull	LSHS702.00.011	set	without cylinder hole
	Single-side handle + flush pull	LSHS702.01.011		with cylinder hole
9	Opening restrictor	LTB70.00.021	pc	
10	Locking plates	LSLP70.01.021	pc	

Note:

The spacers inside the bag of accessories can be ordered with different height dimensions, 25mm, 21mm, 16mm, 13mm.

Items 5 and 8 have the following accessories			
Square spindle (10x10) 100mm	SP10.100	1pc	
Screws	SC6.01.60	2pcs	
Items 6 and 7 contents			
Square spindle (10x10) 100mm	SP10.150	1pc	
Screws	SC6.01.60	2pcs	

Item 4 contents:			
Plastic adaptor	2pcs	M5*16Stainless steel screws	1pc
Plastic cover	2pcs	M5*30Stainless steel screws	1pc
Big spacer	1pc	ST5*20Stainless steel screws	4pcs
Small spacers	5pcs	ST5*40Stainless steel screws	4pcs
Anticollision block	2pcs	ST5*50Stainless steel screws	1pcs
Anti-lifting block	2pcs	ST5*70Stainless steel screws	6pcs
Locking plates	2pcs		

Article number for bag of accessories without locking plates: LSAB70.50.25

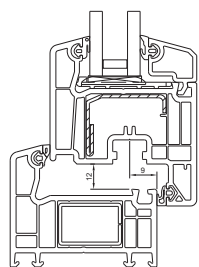

PVC profile

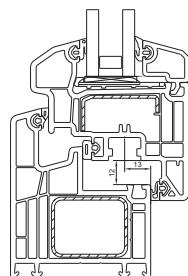

PVC profile

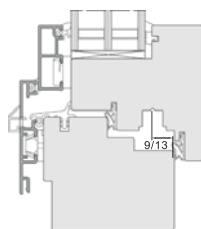

Alu-wood profile

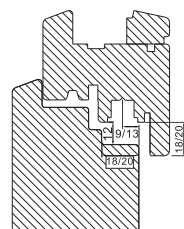

Wood profile

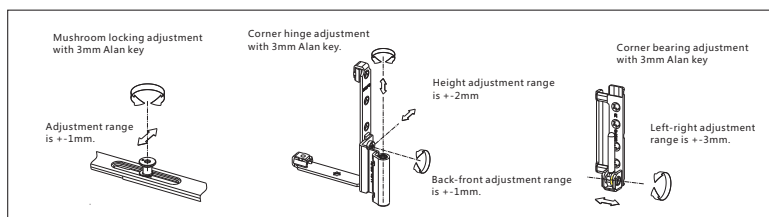
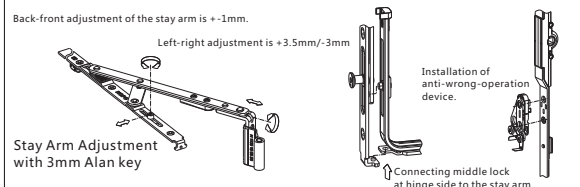
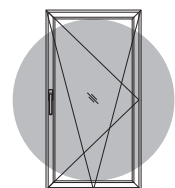

Features of Tilt-turn Windows

1. Ventilation: Tilt position is ideal for ventilation because of ensuring safety of leaf and preventing direct blowing of strong wind.
2. Tilt position will not occupy big space of room.
3. High security level can be achieved with mushroom locking pins well arranged along the window edges.
4. Turn position makes cleaning window very easy.
5. Locking system can achieve high level of sealing effect.
6. Application range: SRH (sash rebate height) = 480mm, SRW (sash rebate width) = 350 - 1600mm
7. Sash weight: Max. 130kg
8. Range of adjustment: vertical ± 3 mm, left to right ± 3 mm, back and front ± 1 mm
9. Surface treatment: galvanized, above 500hrs salt spray-test.
10. Anti-rust solution: all steel parts are made of stainless steel SS304. Note: the SS304 solution used only for profile with 13mm groove position.





- 1 Sliding window & Door
- 2 Lift-sliding door
- 3 Tilt-turn window
- 4 Side-hung window
- 5 Casement window
- 6 Side-hung door
- 7 Passive Leaf
- 8 Side-folding Door

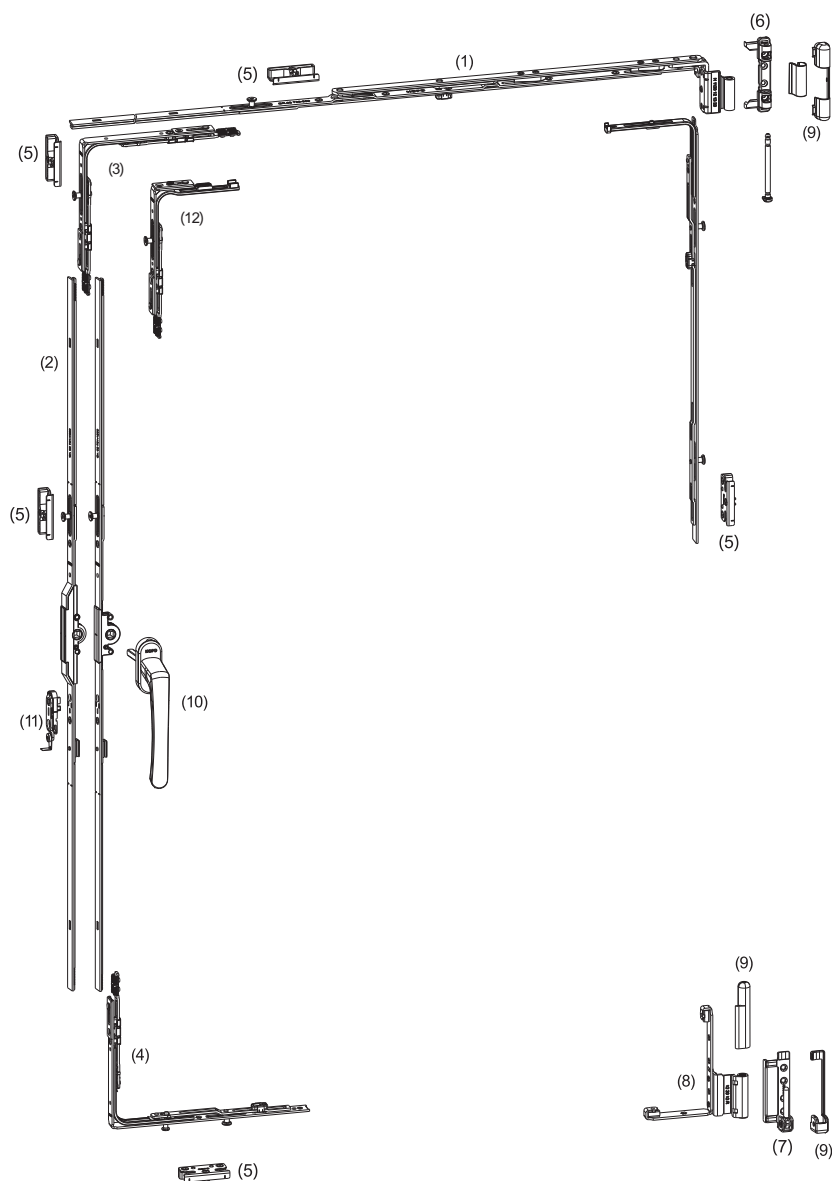

Specification of Tilt-turn Windows

SRH	Description	Article Number	Unit	Q'ty	Number of locking pins	Notes
For profiles with 9mm groove position and 20mm sash rebate						
	1. Stay arm	PSA21.09.04C021L/R	pc	1	0	S 350~560mm
		PSA21.09.06C021L/R	pc		0	R 561~800mm
		PSA21.09.08C021L/R	pc		1	W 801~1050mm
550~700mm	2. Gear transmission	GK10.75.04C021	pc	1	0	
701~1200mm		GK10.75.09C021	pc		1	
1201~1700mm		GK10.75.14C021	pc		1	
	3. Corner transmission	PCT11.00.021	pc	1	1	
	4. Tilt corner transmission	PTCT11.00.021	pc	1	1	
	5. Locking plate	PLP11.09.01C021	pc	2~4		Depend on profile
	6. Stay arm bearing	PSAB20.00.021	pc	1		
	7. Corner bearing	PCB20.00.021R/L	pc	1		
	8. Corner hinge	PCH20.09.021R/L	pc	1		
	9. Bag of covers	PCP20.00.07R/L	set	1		White
	10. Handle	PH100.35.07	pc	1		White
	11. Anti-wrong-operation device	POW10.09.021	pc	1		not available for gear transmission size 04
For profiles with 13mm groove position and 20mm sash rebate						
	1. Stay arm	PSA21.13.04C021R/L	pc	1	0	S 350~560mm
		PSA21.13.06C021R/L	pc		0	R 561~800mm
		PSA21.13.08C021R/L	pc		1	W 801~1050mm
550~700mm	2. Gear transmission	GK10.75.04C021	pc	1	0	
701~1200mm		GK10.75.09C021	pc		1	
1201~1700mm		GK10.75.14C021	pc		1	
	3. Corner transmission	PCT11.00.021	pc	1	1	
	4. Tilt corner transmission	PTCT11.00.021	pc	1	1	
	5. Locking plate	PLP11.13.01C021	pc	2~4		Depend on profile
	6. Stay arm bearing	PSAB20.00.021	pc	1		
	7. Corner bearing	PCB20.00.021R/L	pc	1		
	8. Corner hinge	PCH20.13.021R/L	pc	1		
	9. Bag of covers	PCP20.00.07R/L	set	1		White
	10. Handle	PH100.35.07	pc	1		White
	11. Anti-wrong-operation device	POW10.09.021	pc	1		Optional
For smaller sash width						
Colors	12. Corner transmission	PCT11.20.021	pc	1	1	
		PH100.35.011	pc	1		Anodized silver
		PH100.35.04	pc	1		Anodized brass
	9. Bag of covers	PH100.35.069	pc	1		Black
		PCP20.00.012R/L	set	1		Silver
		PCP20.00.043R/L	set	1		Brass
		PCP20.00.069R/L	set	1		Black

- 1 Sliding window & Door
- 2 Lift-sliding door
- 3 Tilt-turn window
- 4 Side-hung window
- 5 Casement window
- 6 Side-hung door
- 7 Passive Leaf
- 8 Side-folding Door

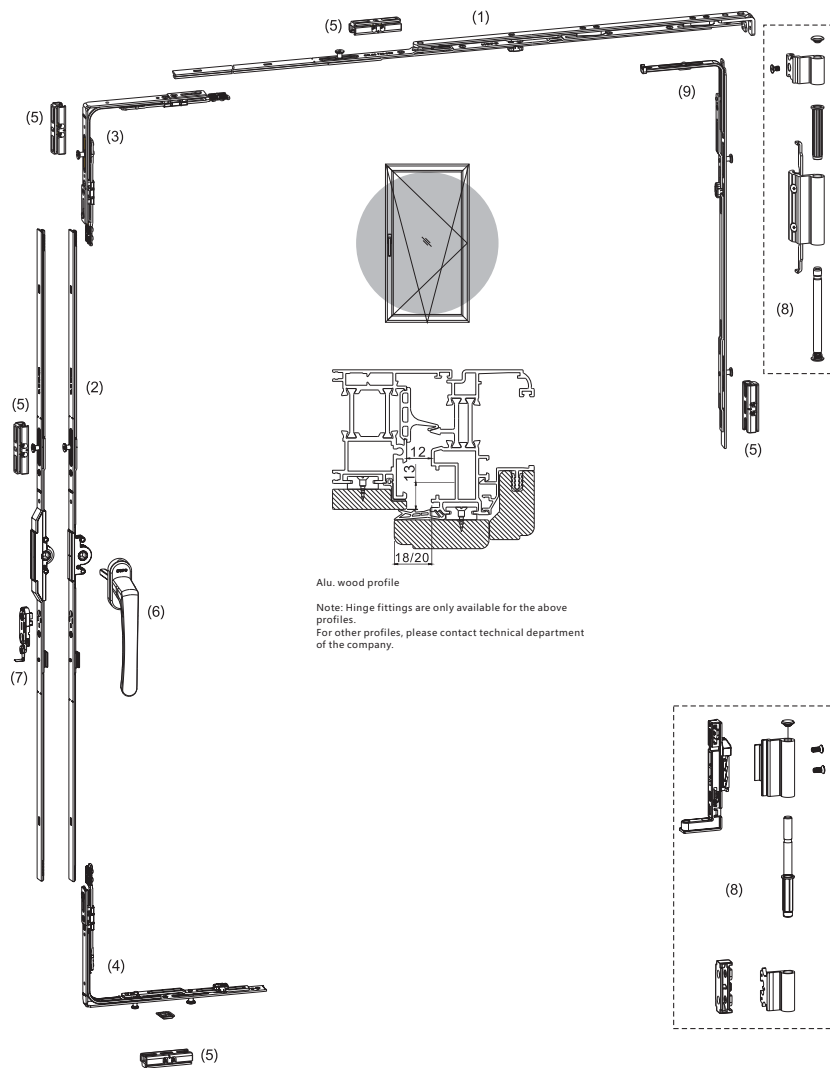

ATT90 - Specification of Tilt-turn Fittings for Alu. wood profile

SRH	Description	Article Number	Unit	Q'ty	Number of locking pins	Notes
For profiles with 9mm groove position and 18/20mm sash rebate						
	1. Stay arm	PSA21.13.04C021L/R	pc	1	0	S 460~560mm
		PSA21.13.06C021L/R	pc		0	R 561~800mm
		PSA21.13.08C021L/R	pc		1	W 801~1050mm
550~700mm	2. Gear transmission	GK10.15.04C021	pc	1	0	
701~1200mm		GK10.15.09C021	pc		1	
1201~1700mm		GK10.15.14C021	pc		1	
	3. Corner transmission	PCT11.00.021	pc	1	1	
	4. Tilt corner transmission	PTCT11.00.021	pc	1	1	
	5. Locking plate	ALP11.13.01C021	pc	2~4		Depend on profile
	6. Handle	PH100.35.07	pc	1		White
	7. Anti-wrong operation device	POW10.09.021	pc	1		Optional
	8. Hinge set	AHA90.00.07	pc	1		White
Optional parts						
	9. Middle lock at hinge side	PMLCT11.05.021	pc	1		
Colors	1. Handle	PH100.35.011	pc	1		Anodized silver
		PH100.35.04	pc	1		Anodized brass
		PH100.35.069	pc	1		Black
	8. Hinge set	AHA90.00.011	set	1		Silver
		AHA90.00.04	set	1		Brass
		AHA90.00.069	set	1		Black

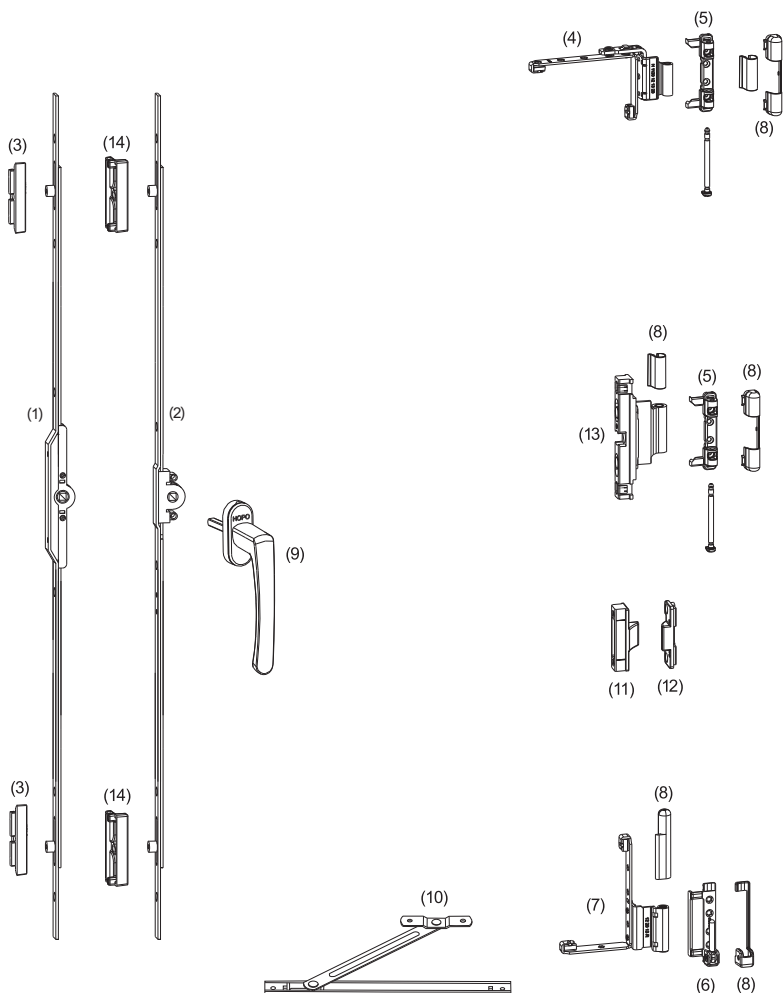

Specification for side-hung inward opening windows

	Description	Article Number	Unit	Q'ty	No. of locking pins
For profiles with 9mm groove position and 20mm sash rebate					
7.5mm Backset	1. Gear	GV20.75.04C021	pc	1	2 locking pins
		GV20.75.06C021			
		GV20.75.08C021			
		GV20.75.10C021			
		GV20.75.12C021	pc	1	3 locking pins
		GV20.75.14C021			
		GV20.75.16C021			
15mm Backset	2. Gear	GV20.15.04C021	pc	1	2 locking pins
		GV20.15.06C021			
		GV20.15.08C021			
		GV20.15.10C021			
		GV20.15.12C021	pc	1	3 locking pins
		GV20.15.14C021			
		GV20.15.16C021			
	3. Locking plate	PLP10.09.021	pc	2~3	
Hinge parts	4. Upper hinge	PTH20.09.021	pc	1	
	5. Stay arm bearing	PSAB20.00.021	pc	1	
	6. Corner bearing	PCB20.00.021R/L	pc	1	
	7. Corner hinge	PCH20.09.021R/L	pc	1	
	8. Bag of covers	PCP20.00.07R/L	bag	1	White
	9. Handle	PH100.35.07	pc	1	White
	10. Opening restrictor	TR16.18.16.12C38	pc	1	
Optional middle hinge can improve sealing effect when sash height is more than 900mm					
	11. Concealed middle hinge, frame part	PCMHF10.09.021	pc	1	
	12. Concealed middle hinge, sash part	PCMHS10.00.021	pc	1	
Middle hinge	13. Middle hinge	PMH20.09.021	pc	1	
	5. Stay arm bearing	PSAB20.00.021	pc	1	
	8. Bag of covers	PCP20.00.07R/L	bag	1	
For profiles with 13mm groove position and 20mm sash rebate					
Replace hinge part with	4. Upper hinge	PTH20.13.021	pc	1	
	5. Stay arm bearing	PSAB20.00.021	pc	1	
	6. Corner bearing	PCB20.00.021R/L	pc	1	
	7. Corner hinge	PCH20.13.021R/L	pc	1	
	8. Bag of covers	PCP20.00.07R/L	bag	1	White
Replace locking plate with	14. Locking plate	PLP10.13.02C021	pc	2~3	
Replace middle hinge with	13. Middle hinge	PMH20.13.021	pc	1	
	5. Stay arm bearing	PSAB20.00.021	pc	1	
	8. Bag of covers	PCP20.00.07R/L	bag	1	



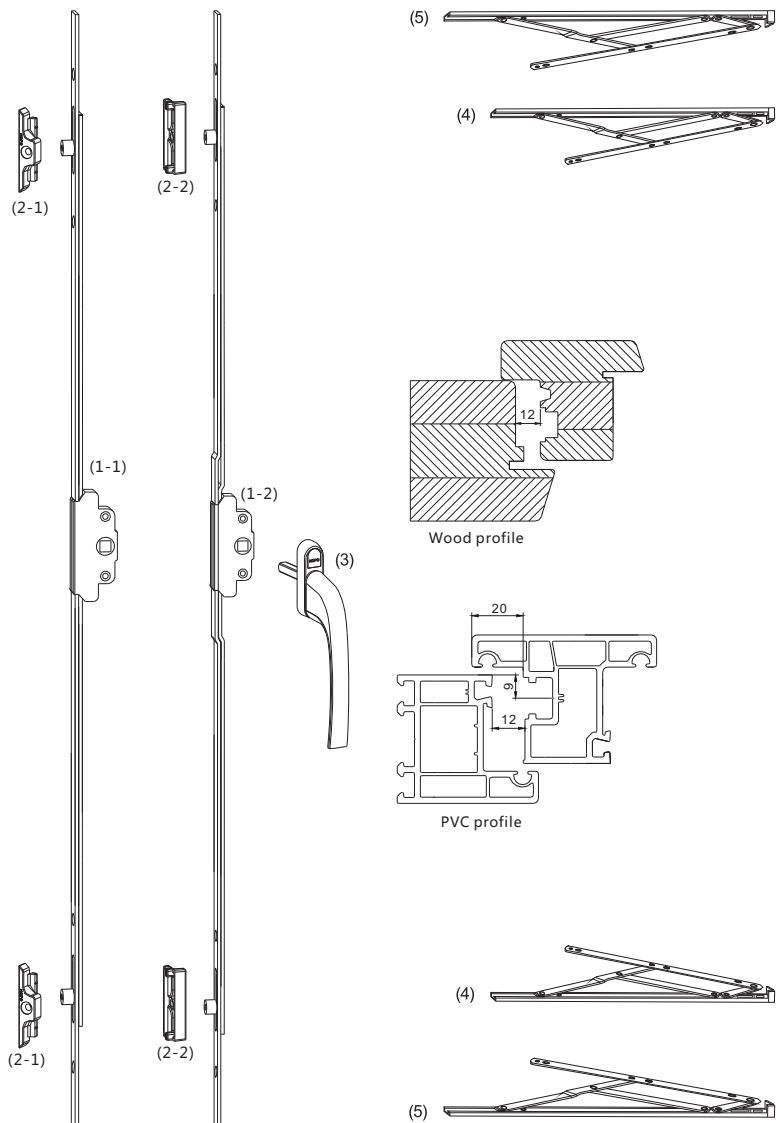

Casement window (groove position 9mm, sash rebate 20mm)

	Description	Article Number	Unit	Q'ty	Notes
19mm Backset	1-1. Gear transmission	GV31.19.04C021	pc	1	2 locking plates
		GV31.19.06C021	pc		
		GV31.19.08C021	pc		
		GV31.19.10C021	pc	1	3 locking plates
		GV31.19.12C021	pc		
		GV31.19.14C021	pc		
22mm Backset	1-2. Gear transmission	GV31.22.04C021	pc	1	2 locking plates
		GV31.22.06C021	pc		
		GV31.22.08C021	pc		
		GV31.22.10C021	pc	1	3 locking plates
		GV31.22.12C021	pc		
		GV31.22.14C021	pc		
	2-1. Locking plate	PLP10.09.021	pc	2`3	According to profile
	2-2. Locking plate	PLP10.13.02C021	pc		
	3. Handle for casement window	PH310.40.07	pc	1	White
	4. Standard friction hinge Overlay height 13.5mm	SFH18.13.12C38	pair	1	Opening angle 64 degree
		SFH18.13.14C38			Opening angle 55 degree
		SFH18.13.16C38			Opening angle 55 degree
	5. Heavy duty friction hinge Overlay height 16.5mm	HFH22.16.12C38	pair	1	Opening angle 87 degree
		HFH22.16.14C38			Opening angle 88 degree
		HFH22.16.16C38			Opening angle 89 degree



Friction hinge

3 kinds of friction hinges with overlay heights of 13.5mm, 16.5mm and 17mm can be chosen for different profiles and different load. HOPO friction hinges are made of stainless steel SS304.

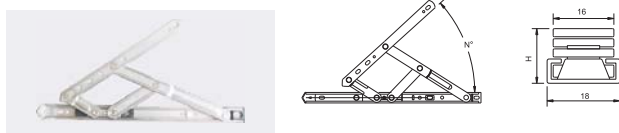
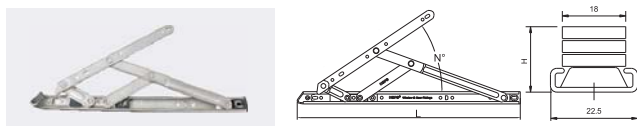

Technical Specifications of Standard Friction hinges

Length(in)	Open Angle	Overlay height	Max. Vent weight	Steel plate thickness	Article number
08"	87°	13.5mm	12kg	2.0mm	SFH18.13.08C38
10"	87°	13.5mm	16kg	2.0mm	SFH18.13.10C38
12"	64°	13.5mm	22kg	2.0mm	SFH18.13.12C38
14"	55°	13.5mm	22kg	2.0mm	SFH18.13.14C38
16"	55°	13.5mm	24kg	2.0mm	SFH18.13.16C38
08"	87°	16.5mm	16kg	2.5mm	SFH18.16.08C38
10"	87°	16.5mm	22kg	2.5mm	SFH18.16.10C38
12"	64°	16.5mm	25kg	2.5mm	SFH18.16.12C38
14"	55°	16.5mm	30kg	2.5mm	SFH18.16.14C38
16"	55°	16.5mm	32kg	2.5mm	SFH18.16.16C38

Technical Specifications of Enhanced Friction hinges

Length(in)	Open Angle	Overlay height	Max. Vent weight	Steel plate thickness	Article number
10"	87°	16.5mm	25kg	2.5mm	HFH22.16.10C38
12"	87°	16.5mm	30kg	2.5mm	HFH22.16.12C38
14"	87°	16.5mm	32kg	2.5mm	HFH22.16.14C38
16"	87°	16.5mm	35kg	2.5mm	HFH22.16.16C38
18"	87°	16.5mm	38kg	2.5mm	HFH22.16.18C38
20"	87°	16.5mm	41kg	2.5mm	HFH22.16.20C38
22"	55°	16.5mm	48kg	2.5mm	HFH22.16.22C38

Technical Specifications of Heavy Duty Friction hinges

Length(in)	Open Angle	Overlay height	Max. Vent weight	Steel plate thickness	Article number
10"	87°	17mm	30kg	3.0mm	FH01.2216.10C38
12"	87°	17mm	35kg	3.0mm	FH01.2216.12C38
14"	87°	17mm	38kg	3.0mm	FH01.2216.14C38
16"	87°	17mm	40kg	3.0mm	FH01.2216.16C38
18"	87°	17mm	43kg	3.0mm	FH01.2216.18C38
20"	87°	17mm	46kg	3.0mm	FH01.2216.20C38
22"	55°	17mm	53kg	3.0mm	FH01.2216.22C38
22"	55°	17mm	56kg	3.0mm	FH01.2216.24C38

Opening restricter

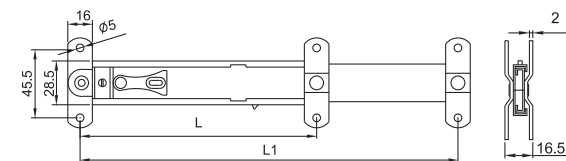

Size	Closing Length	Extending length	Article Number
06	158	208	SS17.06C38
08	207	306	SS17.08C38
10	258	408	SS17.10C38
12	308	508	SS17.12C38

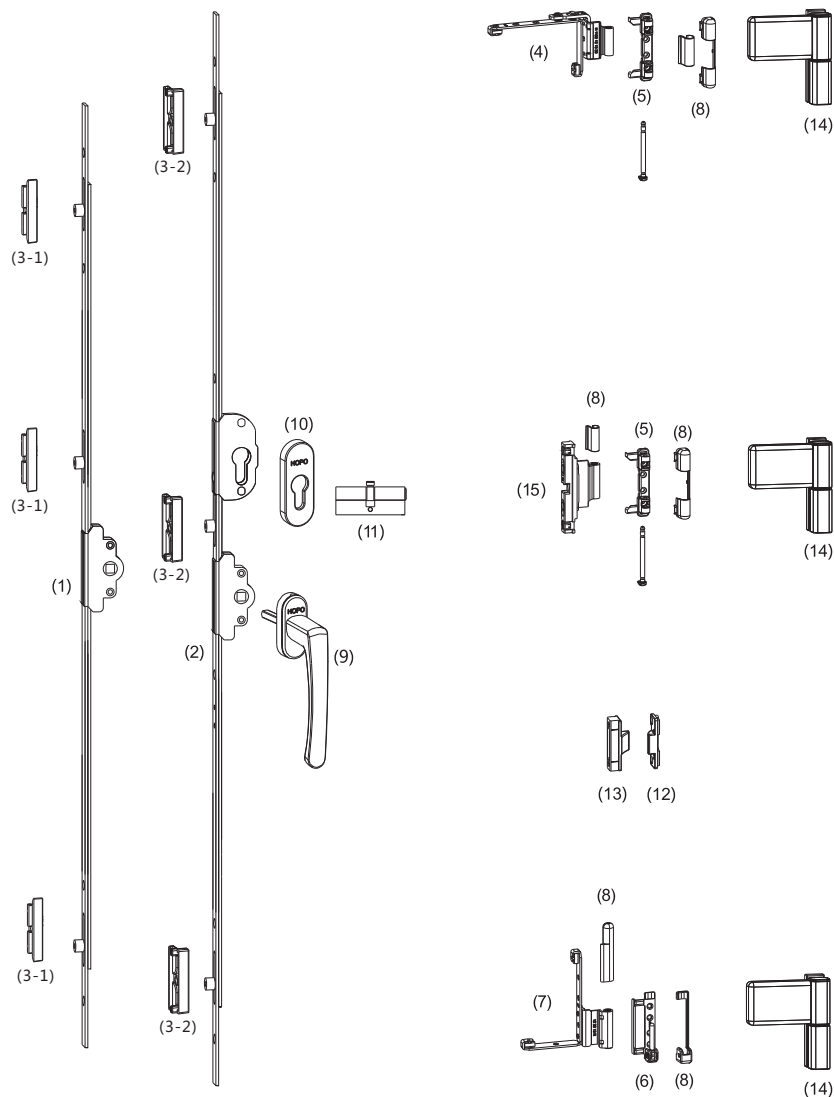

Specifications for Single-leaf Doors

	Description	Article Number	Unit	Q'ty	Notes
For profiles with 9mm groove position and 20mm sash rebate					
25mm Backset	1. Gear transmission, center fixing	GV20.25.16C021	pc	1	3 locking pins
30mm Backset		GV20.25.18C021			
		GV20.25.20C021			
		GV20.30.16C021			
		GV20.30.18C021			
		GV20.30.20C021			
25mm Backset	2. Gear transmission with cylinder, center fixing	GV21.25.16C021	pc	1	
30mm Backset		GV21.25.18C021			
		GV21.25.20C021			
		GV21.30.16C021			
		GV21.30.18C021			
		GV21.30.20C021			
Hinge parts					
	3-1. Locking plate	PLP10.09.021	pc	3	
	4. Top hinge	PTH20.09.021	pc	1	
	5. Stay arm bearing	PSAB20.00.021	pc	1	
	6. Corner bearing	PCB20.00.021R/L	pc	1	
	7. Corner hinge	PCH20.09.021R/L	pc	1	
	8. Bag of covers	PCP20.00.07R/L	bag	1	
Option for Gear transmission without cylinder					
	9. Single side handle	PH100.35.07	pc	1	
Option for Gear transmission with cylinder					
	9. Double sides handle set	PH100.00.07	pc	1	
	Square spindle(7x7)102mm	SP7.102	pc	1	Depends on profiles
	10. Rosettes for Cylinder	CC50.0707	set	1	White, both sides
	11. Cylinder	C98.4040C4T029	pc	1	Depends on profiles
1. Option for middle hinge for sash height more than 900mm					
	12. Concealed middle hinge, frame part	PCMHF10.09.021	pc	1	
	13. Concealed middle hinge, sash part	PCMHS10.00.021	pc	1	
2. 3D hinges can replace the hinge parts					
	14. 3D adjustable hinge	PTH51.00.07	pc	2~3	White
		PTH51.00.069			Black
		PTH51.00.043			Bronze
		PTH51.00.012			Silver
For profiles with 13mm groove position and 20mm sash rebate					
Hinge parts					
	4. Top hinge	PTH20.13.021	pc	1	
	5. Stay arm bearing	PSAB20.00.021	pc	1	
	6. Corner bearing	PCB20.00.021R/L	pc	1	
	7. Corner hinge	PCH20.13.021R/L	pc	1	
	8. Bag of covers	PCP20.00.07R/L	bag	1	White
Locking plate					
	3-2. locking plate	PLP10.13.02C021	pc	3	
Middle hinge					
	15. Middle hinge	PMH20.13.021	pc	1	
	5. Stay arm bearing	PSAB20.00.021	pc	1	
	8. Bag of covers	PCP20.00.07R/L	bag	1	
Colors					
	8. Bag of covers	PCP20.00.012R/L	bag	1	Silver
		PCP20.00.043R/L	bag	1	Bronze
		PCP20.00.069R/L	bag	1	Black
	9. Handle	PH100.35.011	pc	1	Anodized silver
		PH100.35.04	pc	1	Anodized bronze
		PH100.35.069	pc	1	Black



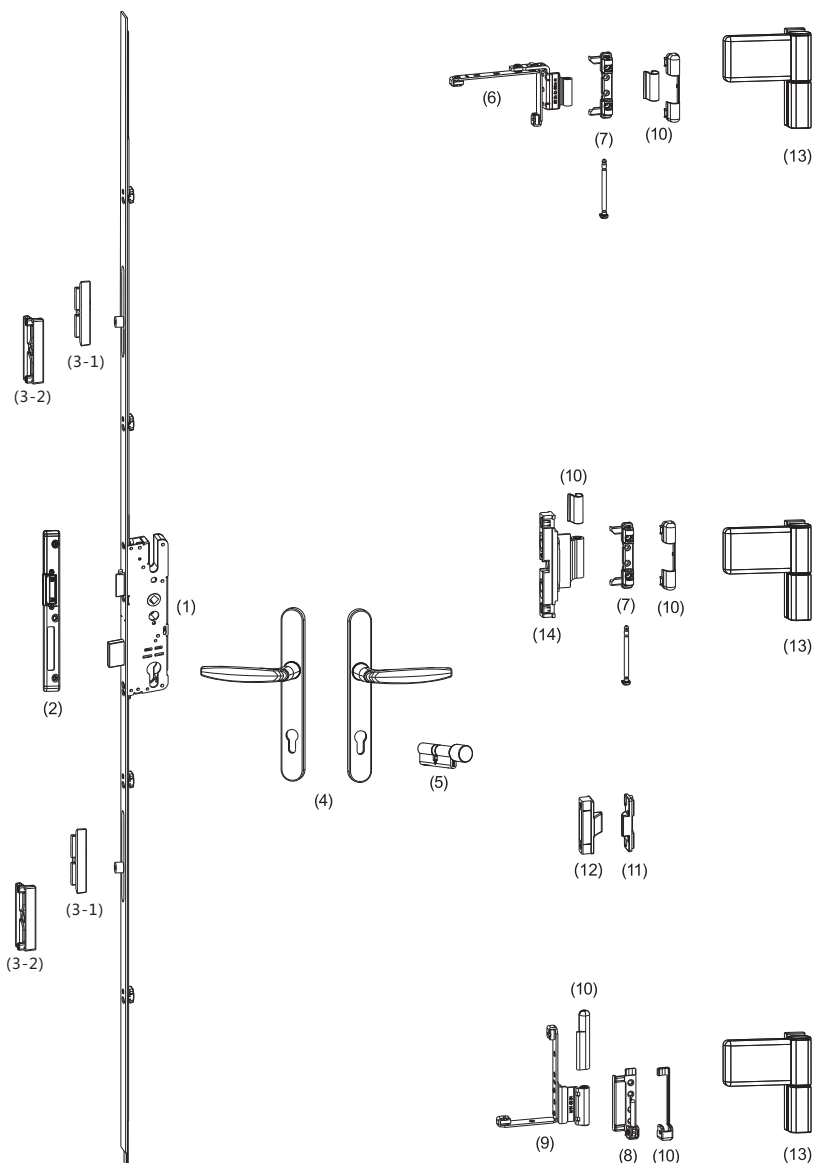

Specification of Handle-operated Multi-points Lock for Single Door

	Description		Article Number	Unit	Q'ty	Notes
For profiles with 9mm groove position and 20mm sash rebate						
35mm/92mm	1. Handle-operated Multi-points Lock		SDLH51.35.16C	pc	1	Length: 2180mm
	2. Adjustable locking plate for door	GP 9mm, left	ALPD50.01.021L	pc	1	According to profiles
		GP 9mm, right	ALPD50.01.021R			
		GP 13mm, left	ALPD50.02.021L			
		GP 13mm, right	ALPD50.02.021R			
		Movable mullion, GP 9mm, left	ALPD50.03.021L			
		Movable mullion, GP 9mm, right	ALPD50.03.021R			
		Movable mullion, GP 13mm, left	ALPD50.04.021L			
		Movable mullion, GP 13mm, right	ALPD50.04.021R			
		Movable mullion, no groove, left	ALPD50.06.021L			
Movable mullion, no groove, right	ALPD50.06.021R					
Hinge parts	3-1. Locking plate		PLP10.09.021	pc	4	
	4. Double-sides door handle		HSD531.0707	set	1	White
	Square spindle (8x8) 110mm		SP8.110	pc	1	According to profile
	Screws		SC5.01.75		3	
	5. Cylinder with knob		C99.4040C4T029	pc	1	According to profile
	6. Top hinge		PTH20.09.021	pc	1	
	7. Stay arm bearing		PSAB20.00.021	pc	1	
	8. Corner bearing		PCB20.00.021R/L	pc	1	
	9. Corner hinge		PCH20.09.021R/L	pc	1	
	10. Bag of covers		PCP20.00.07R/L	bag	1	
1. Optional middle hinge for sash height more than 900mm						
	11. Concealed middle hinge, frame part		PCMHF10.09.021	pc	1	
	12. Concealed middle hinge, sash part		PCMH510.00.021	pc	1	
2. 3D hinges can replace the hinge parts						
	13. 3D adjustable hinge		PTH51.00.07	pc	2~3	White
			PTH51.00.069			Black
			PTH51.00.043			Bronze
			PTH51.00.012			Silver
For profiles with 13mm groove position and 20mm sash rebate						
Hinge parts	6. Top hinge		PTH20.13.021	pc	1	
	7. Stay arm bearing		PSAB20.00.021	pc	1	
	8. Corner bearing		PCB20.00.021R/L	pc	1	
	9. Corner hinge		PCH20.13.021R/L	pc	1	
	10. Bag of covers		PCP20.00.07R/L	bag	1	White
Locking plate	3-2. locking plate		PLP10.13.02C021	pc	4	Depends on profile
Middle hinge	14. Middle hinge		PMH20.13.021	pc	1	
	7. Stay arm bearing		PSAB20.00.021	pc	1	
	10. Bag of covers		PCP20.00.07R/L	bag	1	
Colors	10. Bag of covers		PCP20.00.012R/L	bag	1	Silver
			PCP20.00.043R/L	bag	1	Bronze
			PCP20.00.069R/L	bag	1	Black
	4. Handle		HSD531.0707R/L	set	1	White
			HSD531.069069R/L	set	1	Black
			HSD531.0404R/L	set	1	Bronze
			HSD531.011011R/L	set	1	Silver
Movable mullion locking plate		PMLP10.09.021	pc	1		
		PMLP10.13.021	pc	1		





Cylinders

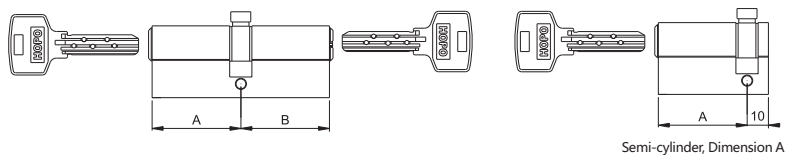

Semi-cylinder, Dimension A

Double-sides Cylinder, Article No. C98. A B C029. Available dimension of A and B:

Dimension A	Dimension B	Notes
25	00	Semi-cylinder
30	25	Normal
35	30	Normal
40	35	Normal
45	40	Normal
50	45	Normal
55	50	Normal
	55	Normal



Cylinders with the different A & B dimensions are available upon request.
Example: C98.3045C029 means A=30mm, B=45mm

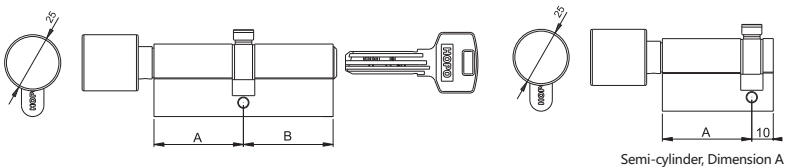

Semi-cylinder, Dimension A

Cylinder with knob (inside), Article No. C99. A B C029. Available dimension of A and B:

Dimension A	Dimension B	Notes
25	00	Semi-cylinder
30	25	Normal
35	30	Normal
40	35	Normal
45	40	Normal
50	45	Normal
55	50	Normal
	55	Normal



Cylinders with the different A & B dimensions are available upon request.
Example: C99.3045C029 means A=30mm, B=45mm

Mortise Lock

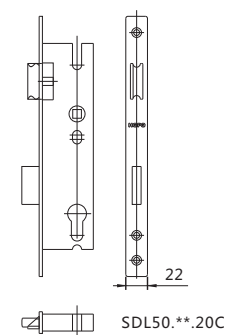

SDL50.**.20C

Center distance 92mm, square spindle 8x8mm
Forend 20mm

	Article No.
Backset32mm	SDL50.32.20C38
Backset26mm	SDL50.26.20C38

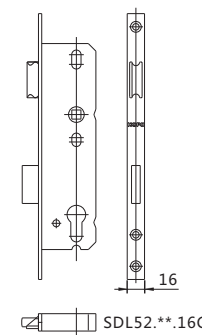

SDL52.**.16C

Center distance 92mm, square spindle 8x8mm
Forend 20mm

	Article No.
Backset28mm	SDL52.28.16C38
Backset35mm	SDL52.35.16C38



Double Sides Handle

The narrow front width (28mm) makes it suitable for PVC and aluminum profiles.
For entrance doors, fixed outside handle solution should be chosen.

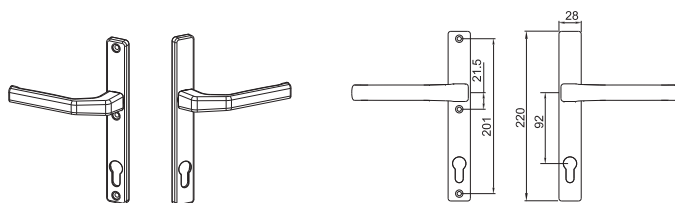

Description	Article Number	Notes
Double-sides Handle	HSD50.0707	White
	HSD50.069069	Black
	HSD50.043043	Bronze (painted)
	HSD50.012012	Silver (painted)

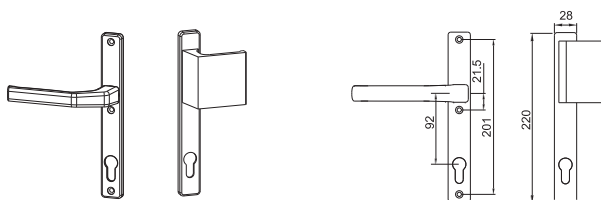

Description	Article Number	Notes
Double-sides Handle	HSD51.0707	White
	HSD51.069069	Black
	HSD51.043043	Bronze (painted)
	HSD51.012012	Silver (painted)

Screws have been hided by the front cover. Width of cover is 32mm.

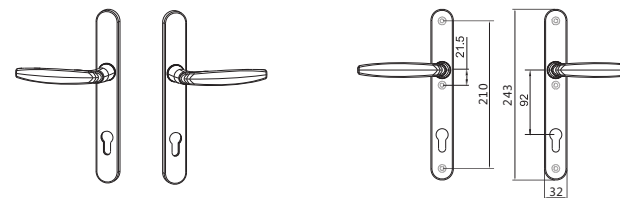

Description	Article Number	Notes
Double-sides Handle	HSD531.0707R/L	White
	HSD531.069069R/L	Black
	HSD531.0404R/L	Bronze (painted)
	HSD531.011011R/L	Silver (painted)

Double-sides Handle with no cylinder hole:HSD541.0707R/L
Handles are fixed, used on passive leaf.

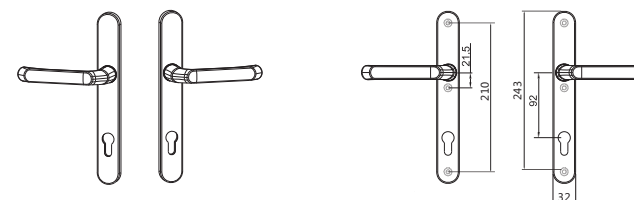

Description	Article Number	Notes
Double-sides Handle	HSD533.0707R/L	White
	HSD533.069069R/L	Black
	HSD533.0404R/L	Bronze (painted)
	HSD533.011011R/L	Silver (painted)

Double-sides Handle with no cylinder hole:HSD543.0707R/L
Handles are fixed, used on passive leaf.



Hinges

- 1 Sliding window & Door
- 2 Lift-sliding door
- 3 Tilt-turn window
- 4 Side-hung window
- 5 Casement window
- 6 Side-hung door
- 7 Passive Leaf
- 8 Side-folding Door



Adjustment range of A : min105.3-2 ; max105.3+4
Adjustment range of B : min16.5-2 ; max16.5+2
Adjustment range of C : min27-5 ; max27+5

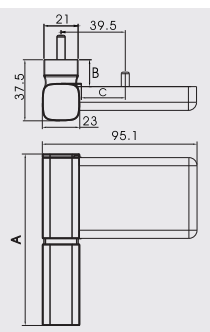

PTH51.00.069



Adjustment range of A : min105.3-2 ; max105.3+4
Adjustment range of B : min16.5-2 ; max16.5+2
Adjustment range of C : min42-5 ; max42+5

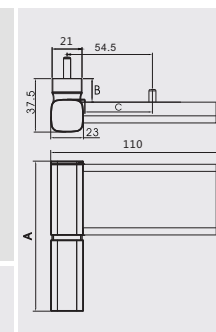

PTH51.10.012



Adjustment range of A : min94-1 ; max94+4
Adjustment range of B : min13.5-1 ; max13.5+3
Adjustment range of C : min33-3 ; max33+7

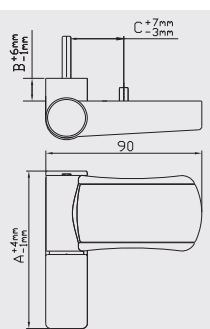

PTH52.00.069



Adjustment range:
up-down +3mm, left-right +2mm,
front-back +0.5mm

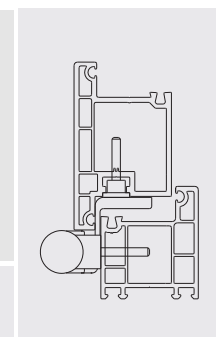

PBH50.00.04

- 1 Sliding window & Door
- 2 Lift-sliding door
- 3 Tilt-turn window
- 4 Side-hung window
- 5 Casement window
- 6 Side-hung door
- 7 Passive Leaf
- 8 Side-folding Door



Solution I

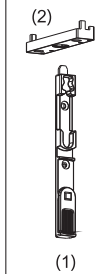

Solution II

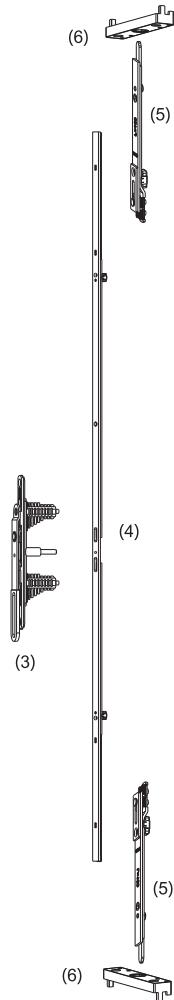

Solution III

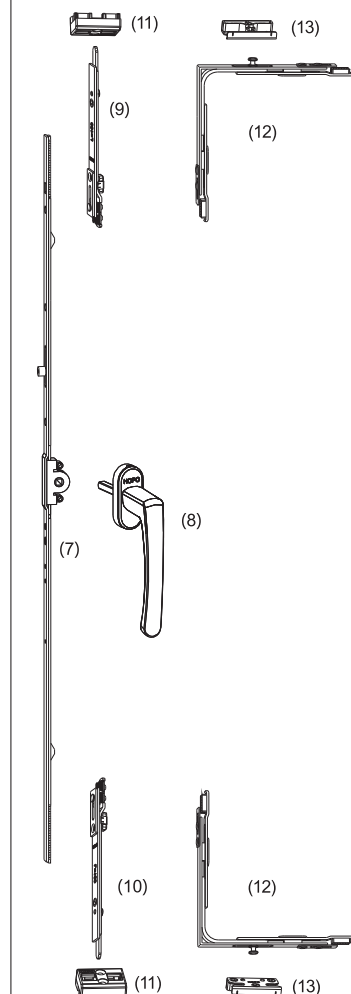

Specification for Passive Solutions

	Description	Article Number	Unit	Q'ty	Notes
For profiles with 9mm groove position and 20mm sash rebate					
Solution I	1. Manual shoot bolt	PMSB20.02.021	pc	2	
	2. Adjustable locking plate for shoot bolt	PSLP20.09.02C021	pc	2	Depends on profiles
Solution II	3. Handle for shoot bolt transmission	PLG50.00.021	pc	1	
	4. Shoot bolt transmission	PLG50.09.021	pc	1	701-1220
		PLG50.16.021			1400-1920
		PLG50.21.021			1900-2400
	5. Shoot bolt	PTSB50.00.021	pc	2	
6. Adjustable shoot bolt locking plate	PSLP20.09.02C021	pc	2	Depends on profiles	
Solution III	7. Gear transmission	GV10.25.09C021	pc	1	Backset 25mm, with teeth
		GV10.25.16C021			
		GV10.25.21C021			
	8. Handle	PH100.35.07	pc	1	
	9. Shoot bolt	PTSB50.00.021	pc	1	
	10. Reverse shoot bolt	PBSB50.00.021	pc	1	
	11. Adjustable locking plate for shoot bolt	PSLP20.09.02C021	pc	2	Depends on profiles
Option for Solution III: replacing shoot bolts with corner transmission					
	12. Corner transmission	PCT11.00.021	pc	2	Mushroom locking pin
	13. Locking plate	PLP11.09.01C021	pc	2	Depends on profiles
For profiles with 13mm groove position and 20mm sash rebate					
	11. Adjustable shoot bolt locking plate	PSLP20.13.02C021	pc	2	Koemmerling
		PSLP20.13.01C021	pc	2	Dimex
	13. Locking plate	PLP11.13.01C021	pc	2	Depends on profiles



Schemes of Sliding Folding Doors

HOPO sliding folding system SF60 can be utilized on aluminum, PVC and wood profiles.
Application range is as the following:

- Max. height: 2700mm (depends on strength of profiles)
- Max. width: 800mm
- Max. weight of single leaf: 80kg
- Max. number of leaves: 7

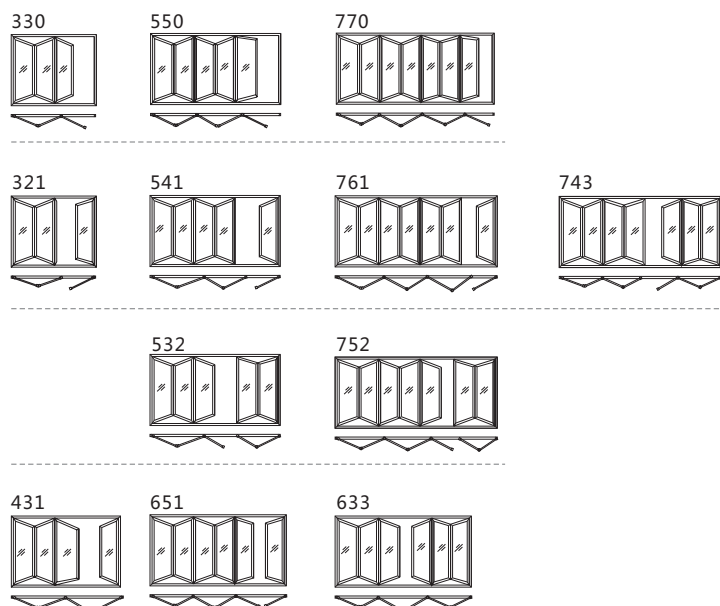

Specification of HOPO SF60 for PVC profiles

1. Bag of rollers

Description	Article Number	Notes
Bag of rollers	PBR60.043	Bronze (painted)
	PBR60.012	Silver (painted)
	PBR60.069	Black (painted)
	PBR60.07	White (painted)

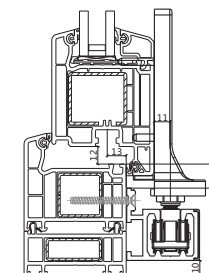
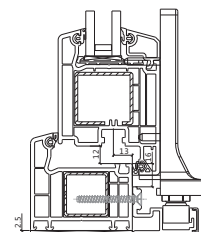
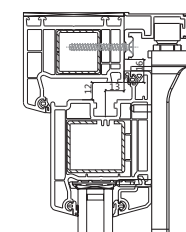
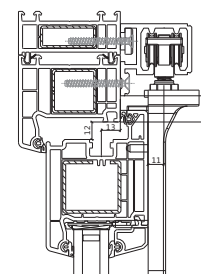



2. Box of hinges (for PVC profiles)

Description	Article Number	Notes
Box of hinges	PSH60.3050.XX	XX:
	PSH60.2050.XX	043 Bronze (painted)
	PSH60.2044.XX	012 Silver (painted)
	PSH60.2044S.XX	069 Black (painted)
	PSH60.3044.XX	07 White (painted)

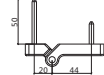
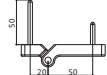
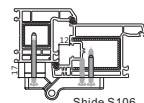
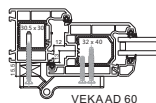
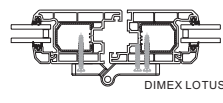
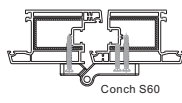
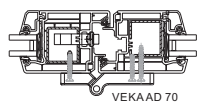

3. Additional bag of profiles

Description	Article Number	Notes
Additional bag of profiles SF60	PABP60.40.07	White, length: 4M
	PABP60.40.06	Black, length: 4M
Barrier free running track	PABPW60.45.07	Length: 4.5M

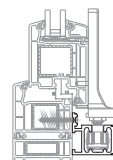
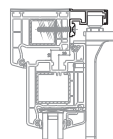
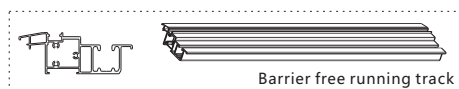
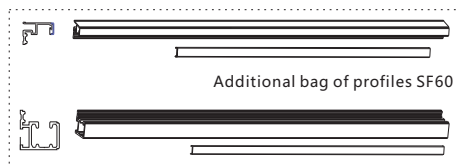

5. Sample specifications

HOPO SF60 for VEKA AD70

Items	Description	Article number	Quantity			Unit	Notes
			Scheme				
			321	541/532	761/752/743		
1	Box of rollers, white	PBR60.07	1	2	3	set	Basic parts
2	Hinge for side panel, 20-50mm, white	PSH60.2050.07	8	8	8	pc	
3	Hinge for folding panel, 30-50mm, white	PSH60.3050.07	4	12	20	pc	
4	Additional bag of profiles	PABP60.40.07	1	1	1	set	Folding passive leaves
5	Short neck handle, white	PH172.40.07	1	2	3	pc	
6	Gear transmission with tooth, 2100mm	GV10.30.21C021	1	2	3	pc	
	Gear transmission with tooth, 1600mm	GV10.30.16C021					Active leaf
7	Top shoot bolt	PTS850.00.021	1	2	3	pc	
8	Bottom shoot bolt	PBS850.00.021	1	2	3	pc	
9	Shoot bolt locking plate	PSLP20.13.01C021	2	6	6	pc	Active leaf
10	Handle-operated multi-points handle	SDLH51.35.16C	1	1	1	pc	
11	Door locking plate (on movable mullion)	ALPD50.03L/R	1	1	1	pc	
12	Locking plate (on movable mullion)	PMLP10.09.021	4	4	4	pc	
13	Cylinder	C98.4550C4T029	1	1	1	pc	
14	Double-sides door handle, white	HSD533.0707R/L	1	1	1	set	

ItemsDescriptionArticle numberQuantityUnitNotes
Scheme

Items	Description	Article number	Quantity						Unit	Notes
			Scheme							
			330	550	770	431	633/651			
1	Box of rollers, white	PBR60.07	1	2	3	1	2	set	Basic parts	
2	Hinge for side panel, 20-50mm, white	PSH60.2050.07	4	4	24	8	8	pc		
3	Hinge for folding panel, 30-50mm, white	PSH60.3050.07	8	16	1	8	16	pc		
4	Additional bag of profiles	PABP60.40.07	1	1	3	1	1	set		
5	Short neck handle, white	PH172.40.07	1	2	3	2	3	pc	Folding passive leaves	
6	Gear transmission with tooth, 2100mm	GV10.30.21C021	1	2	3	2	3	pc		
	Gear transmission with tooth, 1600mm	GV10.30.16C021								
7	Top shoot bolt	PTS850.00.021	1	2	3	2	3	pc		
8	Bottom shoot bolt	PBS850.00.021	1	2	3	2	3	pc		
9	Shoot bolt locking plate	PSLP20.13.01C021	2	4	6	4	6	pc		
10	Handle-operated multi-points handle	SDLH51.35.16C	1	1	1	1	1	pc		
11	Door locking plate (on movable mullion)	ALPD50.03.021L/R	1	1	1	1	1	pc		
12	Locking plate (on movable mullion)	PMLP10.13.021	4	4	4	4	4	pc	Active leaf	
13	Cylinder	C98.4550C4T029	1	1	1	1	1	pc		
14	Double-sides door handle, white	HSD533.0707R/L	1	1	1	1	1	set		



**Dream can be realized
only with insistence**

The most difficult thing for realizing your idea is often the first step you realize it.

To arm your dream with bravery,

you will achieve the final target after overcoming all difficulties.