

# HOPO

**HOPO<sup>®</sup>**  
All man' s dignity lies in thought



HOPE Group Technology Company LTD.  
HOPO China R & D Center, Shenzhen

Tel:  
(86)755 86610062  
(86)755 86610182

Fax:  
(86)755 26742669  
(86)755 86611663  
[Http://www.hopo.us](http://www.hopo.us)  
[Http://www.hopo.hk](http://www.hopo.hk)  
E-mail:[sales@hopo.us](mailto:sales@hopo.us)



HOPO Public Wechat  
HOPO 公众微信



HOPO website  
HOPO 官方网站

从普通的推拉门窗系统，以及滑轮和执手开始，我们的产品已延伸至所有的门窗系统，包括电动通风器和排烟排热系统。我们的目的是帮助门窗、幕墙公司提供最完善的系统解决方案。对于现代建筑而言，提供与之配套的拥有高质量、高性能的产品，一直都是我们的目标！

与国际知名门窗公司合作的经验，提升了我们的质量控制系统，同时也使我们更加注重环保的理念。表面电镀处理的三价铬（不会对身体以及环境造成损害）是我们所有产品的标准工艺。

利润决定一家公司的生死存亡。但是质量、人性化以及环保的理念则是公司可持续发展的必要条件，这也是我们的产品进步和发展的基本原则和动力。

HOPO目前在中国和东南亚市场销售产品已经涉及到门窗五金、窗用和居室用通风器和空气治理系统、门窗智能开启等。在以上领域我们可以提供完善的产品应用方案设计，或者完善的门窗系统、新风系统、智能开窗系统的设计协助和方案更新。

HOPO门窗五金不仅适用于PVC型材、木型材，还适用于铝合金型材。五金系统包括欧标的内平开、外平开、幕墙外平开系统、大的阳台门五金，如提升推拉、折叠系统将给您带来更开阔的视野。

装在窗户上的通风器为解决通风与隔音、防尘之间的矛盾提供了理想的解决方案。电动开窗器和与之配套的控制盒可以安装在公共场合的窗户上，如学校、医院、写字楼和机场的候机楼等。自报警系统确保人们能及时逃生，火警能够进行有效的救援，甚至能防止楼房因火灾的影响而倒塌。

Starting from normal sliding windows and doors solutions, including roller carriages and handles, our product range has been expanding to all kinds of window and patio door fittings systems, as well as electric ventilators and RWA system (smoke and heat extraction system with normal ventilation function). Our purpose is to provide systematic solutions for windows and doors fabricators, and curtain wall companies. Highest quality and perfect function to fit various requirements of modern buildings with modern architectural designs is always our target.

Our experience to cooperate with world-wide famous window and door fittings companies improved our quality control system, and emphasized the idea of environment protection. Trivalent chrome, not harmful for health and environment, is the standard process for all of our products that need galvanizing surface treatment.

Profit determines the survival of a company. But quality, the idea of humanity and environment protection make the sustainable development for the company. That is the basic principle and impetus for all of our product improvement and development.

For our present main markets of China and south-east Asia, we can already provide complete solution for window and door fittings, electric ventilators and RWA system. Application service including profile design, hardware allocation, mounting and adjustment ensure perfect function of our fittings.

HOPO window and door fitting systems can be applied to PVC, wood, and aluminum profiles. Fittings systems include standard European inward opening system (tilt-turn, single tilt and turn, double sashes), side-hung outward opening, project outward windows for curtain wall systems. Fittings for large patio sash like lift-sliding, fording system will give you a wide scenery, as well as perfect thermal protection to ensure your comfortability and to save energy.

Ventilator installed on windows provides an ideal solution to solve the contradictory between the requirement for fresh air and protection for noise, dusts, pollens, and bacterium. Electric window opening drives together with relative control systems can centralize the management of windows for public buildings like schools, hospitals, office buildings and terminal building of airports. RWA system will ensure people to escape and firemen to undertake efficient rescue during emergency, and to protect buildings to collapse because of negative pressure by burning.

## 目录

推拉配置方案	4-11
光韵组合	12-13
如梭	14-15
重型推拉门系统	16-17
麦克系列MA锁	18-19
蝴蝶锁配置	20-21
PH900执手	22-23
扁执手	24-25
双层窗配置方案	26-27

## Contents

Specification of sliding door system	4-11
Rhyme of light	12-13
Weaving Shuttle	14-15
Heavy sliding door system	16-17
MACRO Handle lock	18-19
Butter Fly lock specification	20-21
PH900 Handle	22-23
Flat Handle	24-25
Double layer window specification	26-27

# HOPO

## 光韵组合 四扇配置

Rhyme of light combination — four leaves specification

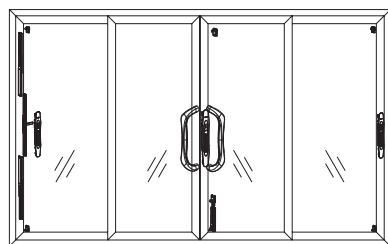
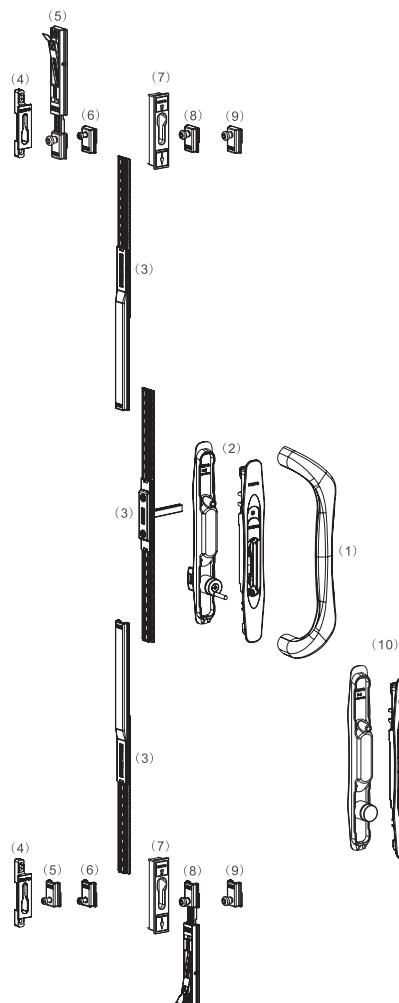
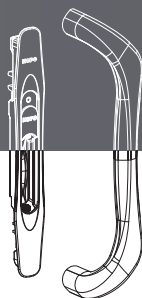

编号 ITEM	名称 DESCRIPTION	货号 ARTICLE NO.	数量 Quantity
(1)	豪华大拉手 Luxury pull handle	BH462. 13. 012	2
(2)	MA锁 带锁芯 MA lock with cylinder	MAL442. 025. 012	1
(3)	T字传动杆套件 T-style connector set	ATDR40. 19. 06	3
(4)	锁座 Locking plate	SLP47. 02. 069	0
(5)	锁点套件 带误操作 Locking pin set with wrong operation	LPES41. 07. 12T38	0
(6)	锁点套件 不带误操作 Locking pin set without wrong operation	LPES40. 07. 12T38	0
(7)	锁座 Locking plate	SLP44. 00. 069	6
(8)	锁点套件 带误操作 Locking pin set with wrong operation	LPES41. 95. 12T38	1
(9)	锁点套件 不带误操作 Locking pin set without wrong operation	LPES40. 95. 12T38	2
(10)	MA锁 不带锁芯 MA lock without cylinder	MAL442. 125. 012	2

# HOPO

## 如梭组合 四扇配置

Weaving shuttle combination — four leaves specification

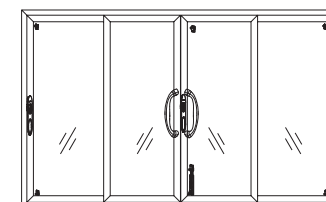
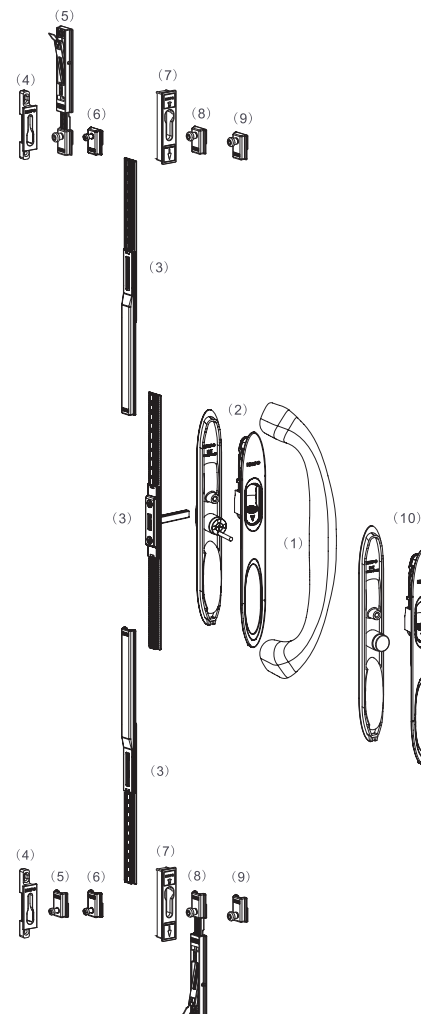
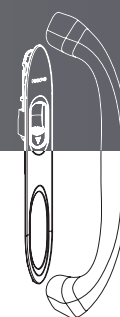

编号 ITEM	名称 DESCRIPTION	货号 ARTICLE NO.	数量 Quantity
(1)	豪华大拉手 Luxury pull handle	BH467. 11. 1T011	2
(2)	MA锁 带锁芯 MA lock with cylinder	MAL440. 025. 012	1
(3)	T字传动杆套件 T-style connector set	ATDR40. 19. 06	3
(4)	锁座 Locking plate	SLP47. 02. 069	0
(5)	锁点套件 带误操作 Locking pin set with wrong operation	LPES41. 07. 12T38	0
(6)	锁点套件 不带误操作 Locking pin set without wrong operation	LPES40. 07. 12T38	0
(7)	锁座 Locking plate	SLP44. 00. 069	6
(8)	锁点套件 带误操作 Locking pin set with wrong operation	LPES41. 95. 12T38	1
(9)	锁点套件 不带误操作 Locking pin set without wrong operation	LPES40. 95. 12T38	2
(10)	MA锁 不带锁芯 MA lock without cylinder	MAL440. 125. 012	2

# HOPO

旋钮执手 四扇配置  
Handle—four leaves specification

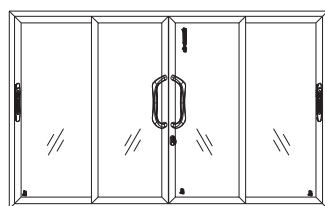
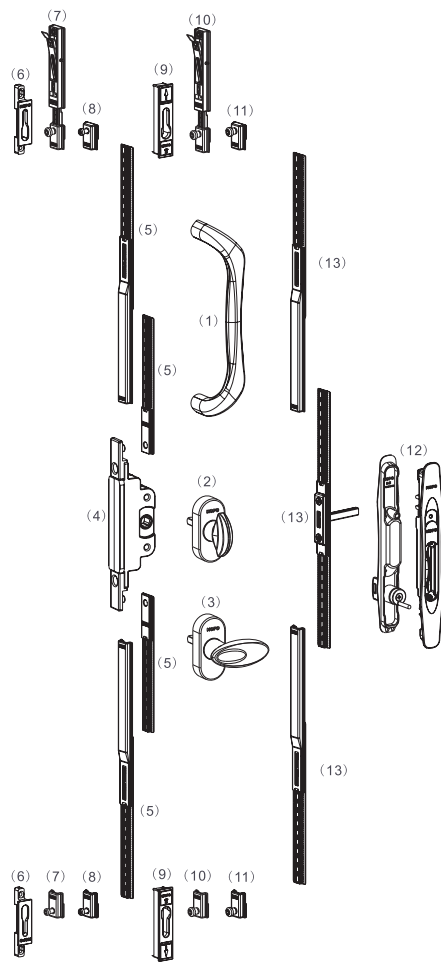
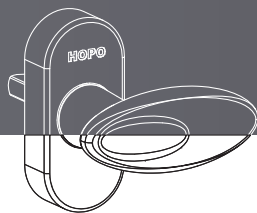

编号 ITEM	名称 DESCRIPTION	货号 ARTICLE NO.	数量 Quantity
(1)	豪华大拉手 Luxury pull handle	BH462. 11. 011	2
(2)	执手 Handle	PH203. 30. 012	1
(3)	执手 Handle	PH204. 30. 012	0
(4)	传动壳 Gear case	AGC30. 23. 012	1
(5)	圆孔传动杆套件 Circular transmission rod set	AHDR40. 00. 06	1
(6)	锁座 Locking plate	SLP47. 02. 069	0
(7)	锁点套件 带误操作 Locking pin set with wrong operation	LPES41. 07. 12T38	0
(8)	锁点套件 不带误操作 Locking pin set without wrong operation	LPES40. 07. 12T38	0
(9)	锁座 Locking plate	SLP44. 00. 069	6
(10)	锁点套件 带误操作 Locking pin set with wrong operation	LPES41. 95. 12T38	1
(11)	锁点套件 不带误操作 Locking pin set without wrong operation	LPES40. 95. 12T38	2
(12)	MA锁 带锁芯 MA lock with cylinder	MAL442. 025. 012	2
(13)	T字传动杆套件 T-style connector set	ATDR40. 19. 06	2

# HOPO

拨叉执手 两扇配置  
Handle—two leaves specification

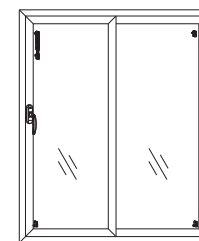
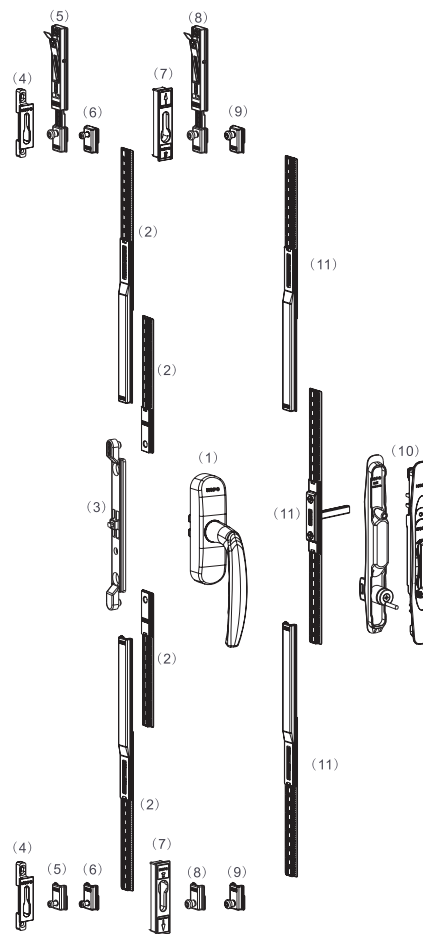
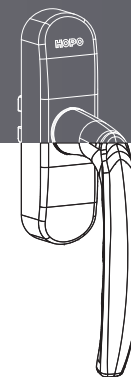

编号 ITEM	名称 DESCRIPTION	货号 ARTICLE NO.	数量 Quantity
(1)	执手 Handle	AH606. 22. 011	1
(2)	圆孔传动杆套件 Circular transmission rod set	AHDR40. 19. 06	1
(3)	转换杆 Parallel transmission	APT10. 00. 021	1
(4)	锁座 Locking plate	SLP47. 02. 069	0
(5)	锁点套件 带误操作 Locking pin set with wrong operation	LPES41. 07. 12T38	0
(6)	锁点套件 不带误操作 Locking pin set without wrong operation	LPES40. 07. 12T38	0
(7)	锁座 Locking plate	SLP44. 00. 069	4
(8)	锁点套件 带误操作 Locking pin set with wrong operation	LPES41. 95. 12T38	1
(9)	锁点套件 不带误操作 Locking pin set without wrong operation	LPES40. 95. 12T38	1
(10)	MA锁 带锁芯 MA lock with cylinder	MAL442. 025. 012	1
(11)	T字传动杆套件 T-style connector set	ATDR40. 19. 06	1

# HOPO

方轴执手 两扇配置  
Handle—two leaves specification

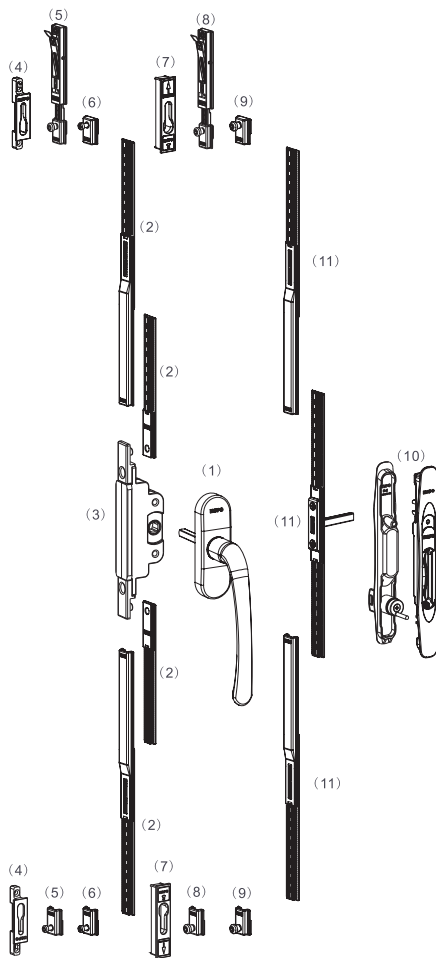

编号 ITEM	名称 DESCRIPTION	货号 ARTICLE NO.	数量 Quantity
(1)	执手 Handle	PH181. 30. 011	1
(2)	圆孔传动杆套件 Circular transmission rod set	AHDR40. 19. 06	1
(3)	传动壳 Gear case	AGC30. 23. 012	1
(4)	锁座 Locking plate	SLP47. 02. 069	0
(5)	锁点套件 带误操作 Locking pin set with wrong operation	LPES41. 07. 12T38	0
(6)	锁点套件 不带误操作 Locking pin set without wrong operation	LPES40. 07. 12T38	0
(7)	锁座 Locking plate	SLP44. 00. 069	4
(8)	锁点套件 带误操作 Locking pin set with wrong operation	LPES41. 95. 12T38	1
(9)	锁点套件 不带误操作 Locking pin set without wrong operation	LPES40. 95. 12T38	1
(10)	MA锁 带锁芯 MA lock with cylinder	MAL442. 025. 012	1
(11)	T字传动杆套件 T-style connector set	ATDR40. 19. 06	1

# HOPO

方轴执手带锁芯 两扇配置  
Handle with cylinder—two leaves specification

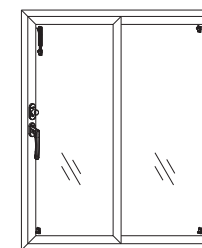
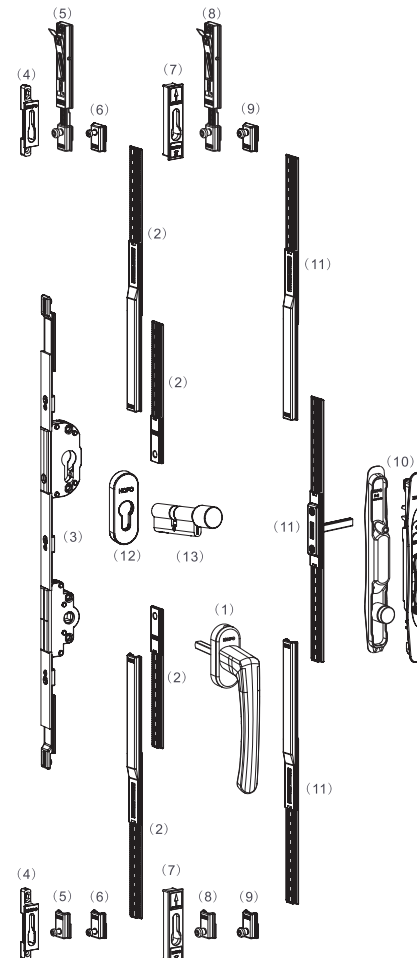

编号 ITEM	名称 DESCRIPTION	货号 ARTICLE NO.	数量 Quantity
(1)	执手 Handle	PH100. 30. 011	1
(2)	圆孔传动杆套件 Circular transmission rod set	AHDR40. 19. 06	1
(3)	C槽带锁传动器 C groove gear box w. cylinder	AGC51. 23. 021	1
(4)	锁座 Locking plate	SLP47. 02. 069	0
(5)	锁点套件 带误操作 Locking pin set with wrong operation	LPES41. 07. 12T38	0
(6)	锁点套件 不带误操作 Locking pin set without wrong operation	LPES40. 07. 12T38	0
(7)	锁座 Locking plate	SLP44. 00. 069	4
(8)	锁点套件 带误操作 Locking pin set with wrong operation	LPES41. 95. 12T38	1
(9)	锁点套件 不带误操作 Locking pin set without wrong operation	LPES40. 95. 12T38	1
(10)	MA锁 不带锁芯 MA lock without cylinder	MAL442. 125. 012	1
(11)	T字传动杆套件 T-style connector set	ATDR40. 19. 06	1
(12)	锁芯盖 Rosette	CC53. 011011	1
(13)	锁芯 Cylinder	C99. 3535C4T029	1

# HOPO

## 双钩锁体+豪华拉手256 四扇配置

Sliding door lock with hook and luxury pull handle 256 — four leaves specification

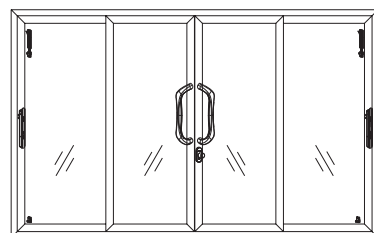
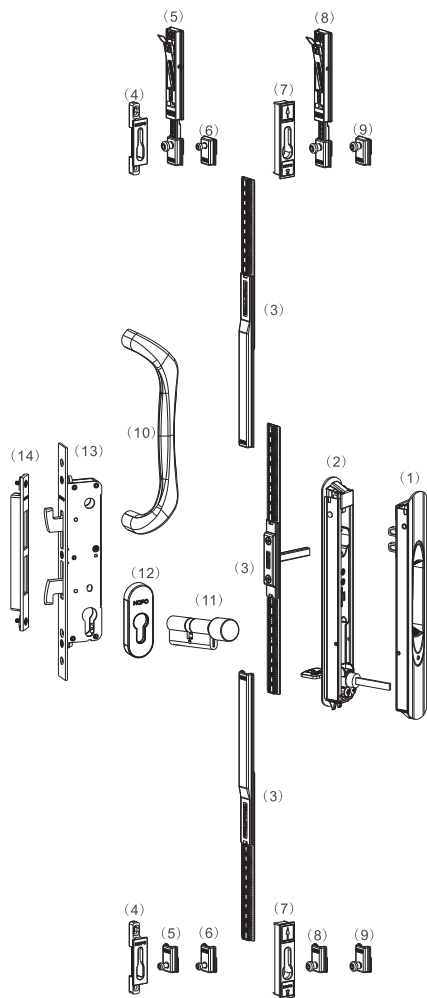

编号 ITEM	名称 DESCRIPTION	货号 ARTICLE NO.	数量 Quantity
(1)	MA锁 MA lock	MA437. 320. 011	2
(2)	MA扣手 MA flash pull	BH61. 20. 011	2
(3)	T字传动杆套件 T-style connector set	ATDR40. 19. 06	2
(4)	锁座 Locking plate	SLP47. 02. 069	0
(5)	锁点套件 带误操作 Locking pin set with wrong operation	LPES41. 07. 12T38	0
(6)	锁点套件 不带误操作 Locking pin set without wrong operation	LPES40. 07. 12T38	0
(7)	锁座 Locking plate	SLP44. 00. 069	4
(8)	锁点套件 带误操作 Locking pin set with wrong operation	LPES41. 95. 12T38	2
(9)	锁点套件 不带误操作 Locking pin set without wrong operation	LPES40. 95. 12T38	0
(10)	豪华大拉手 Luxury pull handle	BH466. 11. 011	2
(11)	锁芯 Cylinder	C99. 3535C4T029	1
(12)	锁芯盖 Rosette	CC53. 011011	1
(13)	锁体 Lock	SDT46. 28. 22C	1
(14)	锁座 Locking plate	SLP48. 03. 069	1

# HOPO

## 双钩锁体+豪华拉手600 四扇配置

Sliding door lock with hook and luxury pull handle 600 — four leaves specification

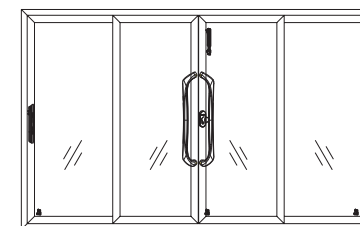
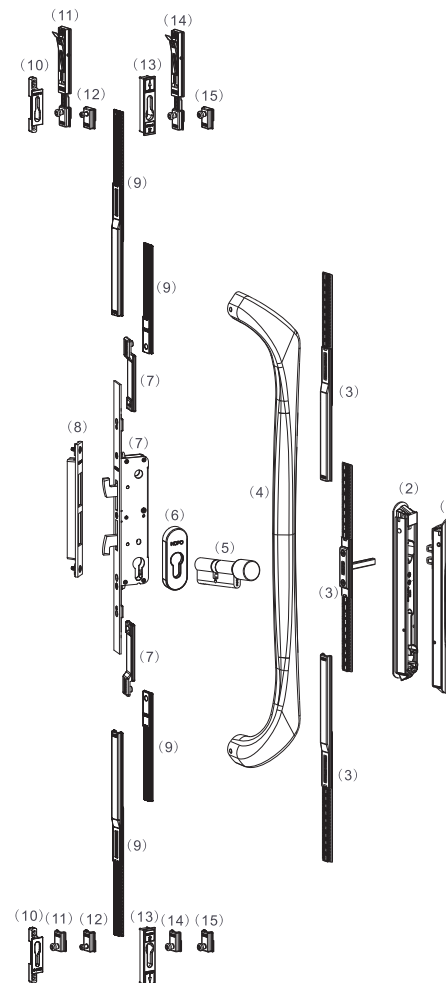

编号 ITEM	名称 DESCRIPTION	货号 ARTICLE NO.	数量 Quantity
(1)	MA锁 MA lock	MA437. 320. 011	2
(2)	MA扣手 MA flash pull	BH61. 10. 011	2
(3)	T字传动杆套件 T-style connector set	ATDR40. 19. 06	2
(4)	豪华大拉手 Luxury pull handle	BH470. 11. 011	2
(5)	锁芯 Cylinder	C99. 3535C4T029	1
(6)	锁芯盖 Rosette	CC53. 011011	1
(7)	锁体 Lock	SDTH46. 28. 22C	1
(8)	锁座 Locking plate	SLP48. 03. 069	1
(9)	圆孔传动杆套件 Gear extension	AHDR40. 00. 06	1
(10)	锁座 Locking plate	SLP47. 02. 069	0
(11)	锁点套件 带误操作 Locking pin set with wrong operation	LPES41. 07. 12T38	0
(12)	锁点套件 不带误操作 Locking pin set without wrong operation	LPES40. 07. 12T38	0
(13)	锁座 Locking plate	SLP44. 00. 069	6
(14)	锁点套件 带误操作 Locking pin set with wrong operation	LPES41. 95. 12T38	1
(15)	锁点套件 不带误操作 Locking pin set without wrong operation	LPES40. 95. 12T38	2



人类艺术史上众多永恒的作品中，梵高的《向日葵》对我有着特殊的吸引力。在这幅画中，光是主角，画家通过向日葵表达了对光的追求，让人感到了希望的诱惑。大面积的弧度，在不同的角度，能够反射出光的不同效果。形状本身并不重要，关键在于对光的表现。在设计MAL442的过程中，结合BH462拉手，我比较了各种形状的效果。在渲图的过程中，随着光线角度和明暗的变化，产品的视觉效果变化无穷。这正是我想追求的效果，对光的表达，对光的崇拜。该产品有两种颜色，不论是古铜色的华丽，或者是银色的冷峻，在推拉门上都表现出光晕的效果，必将成为家居生活的点睛之笔。

The painting of "Vase avec quatorze tournesols" from Van Gogh, among all the immortal works of human art history, is of special attractiveness for me. In the painting, Van Gogh expressed his aspiration to the light through various shapes of sunflowers, and seduction of hope. Large scale of cambered surface has different reflecting effects in different angles of view. Shape is not so important as its expression of light. I have compared reflecting effects of different designs, together with the BH462 pull handle. During procedure of 3D rendering, the light reflecting effect shown countless changes when changing the angle and brightness of light. This is what I desire, the expression and worship of light. The products have two colors, brass and silver. Either the magnificence of brass or the coldness of silver, the MA lock and the pull handle installed on the sliding doors, will surely be the punchline of the life of family.



适用范围：型材为33mm以上 Application instructions: profile which is above 33mm

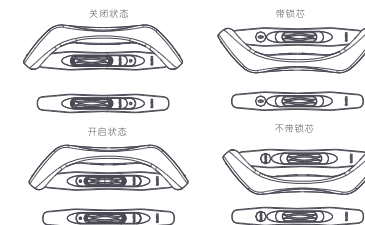

产品名称：豪华大拉手

产品编号：BH462.X#. \*\*

编号说明：BH462拉手的款式：X-表内外、0-表室外、1-表室内；#-表材质，1-硬质氧化铝，3-铝合金；\*\*--表颜色，常规颜色为：银色、古铜色、白色、黑色

产品名称：轻型系列MA锁

规格：203X28.5 (mm)

产品编号：MAL442.025. \*\*

编号说明：MAL442-MA锁的款式：025-0带锁芯，25-拨叉长度25.2mm；\*\*--表颜色，常规颜色为：银色、古铜色、白色、黑色

产品编号：MAL442.125. \*\*

编号说明：MAL440-MA锁的款式：125-1不带锁芯，25-拨叉长度25.2mm；\*\*--表颜色，常规颜色为：银色、古铜色、白色、黑色

Name of good: Luxury Pull Handle

Article No: H462.X#. \*\*

Description: H462-style of handle;X- Inside or outside handle;0-inside handle; 1-outside handle;#-- Surface material; 1- hard alumina, 3-aluminum;\*\*-- surface,Color:, silver, bronze, white, black

Name of good: MA lock of light duty series

Specification: 203X28.5 (mm)

Article No: MAL442.025. \*\*

Description: MAL442-style of MA lock ; 0- with cylinder ; 25-- Carrier fork length of MA lock is 25.2mm ; \*\*--surface ,Color: silver, bronze, white, black

Article No: MAL442.125. \*\*

Description: MAL442-style of MA lock ; 1- without cylinder ; 25-- carrier fork length of MA lock is 25.2mm ; \*\*--surface,Color: silver, bronze, white, black

在我们的生活中，许多历史悠久的造型消失了。技术的进步和生活节奏的加快淘汰了许多东西，甚至使我们忘记了历史，忘记了自然。梭，作为织布的工具，伴随人类历史走过了几千年，现在还有多少人重视它曾经的辉煌。回忆历史不一定仅仅是怀旧，更意味着对文明历史的尊重。MAL440锁的设计灵感正是来源于对梭结构的理解，圆润的端部造型，没有尖锐的张扬，却依然保持着进取的精神。

这款MA锁在功能性结构方面做了创新，将扣手和开关锁的操作分离，提高了中间结构的装饰性，同时在中间为锁芯结构留出了空间。

Lots of shapes, with long history, disappeared. The fast development of technology and increasing of life pace weed out many things, even made us forget history, and forget nature. Shuttle, as a tool of weaving cloths, existed for thousands of years with human history. Few people would notice its glory of the past. Remember the past means not just certain kinds of sentiment, but respect to human civilization. The design inspiration for the MAL440 comes rightly from understanding of shuttle's structure. Round ends of shuttle shows no aggressiveness of sharp, but still remains the forwarding spirit.

This MA lock realize an innovation in aspect of functional structure, dividing pulling and locking/unlocking functions into two structures. Distribution of These sub-structures enhances decorating effect for the middle part of the MA lock, and remains the central point for cylinder.



适用范围：型材为33mm以上 Application instructions: profile which is above 33mm



产品名称：豪华大拉手

产品编号：BH467.X#.\*\*

编号说明：BH467-拉手的款式；X-表内外，0-表室外，1-表室内；#-表材质，1-硬质氧化铝；\*\*--表颜色，常规颜色为：银色、古铜色

产品名称：重型系列MA锁

规格：240X30 (mm)

产品编号：MAL440.025.\*\*

编号说明：MAL440-MA锁的款式；025-0带锁芯；25-拨叉长度26.2mm；\*\*--表颜色，常规颜色为：银色、古铜色、白色、黑色

产品编号：MAL440.125.\*\*

编号说明：MAL440-MA锁的款式；125-1不带锁芯；25-拨叉长度26.2mm；\*\*--表颜色，常规颜色为：银色、古铜色、白色、黑色

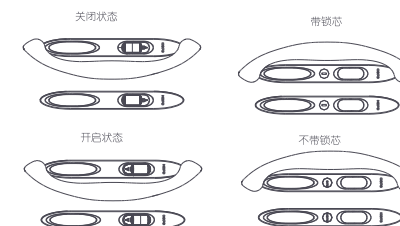

Name of good: Luxury Pull Handle

Article No: H467.X#.\*\*

Description: H467-style of handle; X- Inside or outside handle; 0-inside handle; 1-outside handle; #- Surface material; 1- hard alumina; \*\*-- surface, Color: silver, bronze

Name of good: MA lock of heavy duty series

Specification: 240X30 (mm)

Article No: MAL440.025.\*\*

Description: MAL440-style of MA lock; 0- with cylinder; 25-- Carrier fork length of MA lock is 26.2mm; \*\*--surface, Color: silver, bronze, white, black

Article No: MAL440.125.\*\*

Description: MAL440-style of MA lock; 1- without cylinder; 25-- carrier fork length of MA lock is 26.2mm; \*\*--surface, Color: silver, bronze, white, black



直线的纯粹，纯粹的直线

我的生活很单调：鼠标，键盘，屏幕。没有疲劳，只有倦怠。随手拿起手边的铅笔，在打印过图纸的“二次纸”背面随意画着。由点，到线，再到面。大脑一片空白，笔下只有直线，简单，纯粹。转一下纸，换个角度，铅笔依然重复着同样的动作。突然，面与面相交形成了截面的效果，像什么？是童年看动画片中的变形金刚，还是上中学时的立体几何？直线的纯粹原来也可以带来某种表现力。

最终，这种截面的效果变成了MA锁的造型，有人说像宝剑，有人说像兰博基尼。我想到的还是那直线中包含的纯粹。

Pure Line, and Line with Purity

My life is simple, mouse, key board, and screen. I should not be tired, but just felt ennui. On the back of a used paper, I drew lines with no purpose, from points to line, from lines to surface. My brain was empty, what remained were only lines, simple and pure. Changing angle of the paper, the pencil moved the same. Suddenly, the cutting edge of surfaces appeared as something. What did it like? Transformers in cartoon films in my childhood? Or solid geometry in the age of middle school? The purity of straight lines could means something!

Finally, these surfaces of straight lines became the design of a new MA lock. Some guys called it sward, other guys said it like Lamborghini. What remains in my mind is still the purity contented in the straight lines.



HOPO重型系列MA锁适用于型材厚度33mm以上  
MA lock of HOPO heavy series is applied to the profile which is above 33mm thickness.

HOPO重型系列MA锁  
HOPO MACRO MA LOCK



扣手  
The locking side

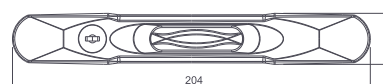

产品名称：重型系列MA锁

规格:204X29(mm)

产品名称：MAL439.XX.##

编号说明：MAL439-MA锁的款式；XX-MA锁的拨叉长度；##-表面处理方式，目前可喷涂颜色：银色、白色、黑色。

Name of product: MACRO MA LOCK

Specification: 204X29(mm)

Article No: MAL439.XX.##

Description for article number: MAL439,MA lock style carrier fork height .Surface finish:spraying color: sliver, white, black



简约是一种人生的态度

麦克系列MA锁的主体遵从简约和大气的的设计原则，与重型铝合金推拉门宽大的型材相协调。

麦克系列MA锁中部的滑块执手采用了弧线的外形设计，中和了主体硬朗的风格，表达了对使用者手感的关心。充裕的执手空间便于四个手指同时操作，使重型门的推拉轻松舒适。

在中部滑块执手的底部有两种装饰性花纹，提供不同的触觉感受。装饰花纹位于滑块执手的底部，体现出一种低调奢华的效果。

作品是设计者自己理念的表达，也是与使用者关于人生态度的交流。简约的人生态度，可以同意也可以反对，但永远值得讨论。

Conciseness is a life attitude.

The design of the main body of the MACRO HANDLE Lock follows the principle of conciseness and generosity, harmonized with the wide aluminium profiles of heavy sliding doors.

Curves of the slipping handle in the central part of the handle lock compensate the straight and tough style of the main body, expressing concern to the touch-feeling of users. Enough space for the four fingers makes it easy to handle the heavy sliding door.

There are two kinds of decorative patterns on the bottom of the central part of the handle lock, alternatives of different finger feelings. Decorative patterns on the black plastic bottom make the luxurious decoration more modest.

Products are expression of designers' own ideas, and communication with users. Conciseness, as a life attitude, can be agreed or disagreed, but is worth to discuss forever.



HOPO麦克系列MA锁适用范围：型材厚度要45mm以上  
Application instruction: The thickness of profile should be 45mm or more

规格：230×32 (mm)  
Specifications: 230×32 (mm)

HOPO麦克系列MA锁的特点是，里外都能锁门；且具有防盗防撬的功能  
Features: The MACRO Lock Handle can be locked from both inside and outside, and have anti-burglary function as well.

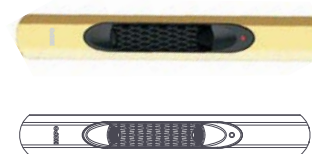

带锁芯的MA扣手  
Flush pull handle with cylinder



不带锁芯的MA扣手  
Flush pull handle with cylinder

BH61.20.011, 银色, 麻花纹, 带锁芯  
BH61.20.04, 古铜色, 麻花纹, 带锁芯  
BH61.10.011, 银色, 麻花纹, 不带锁芯  
BH61.20.04, 古铜色, 麻花纹, 不带锁芯  
BH61.20.011, silver, braided figure, with cylinder  
BH61.20.04, bronze, braided figure, with cylinder  
BH61.10.011, silver, braided figure, without cylinder  
BH61.20.04, bronze, braided figure, without

产品名称：麦克系列MA锁

产品编号：MAL437.XX\*.##

编号说明：MAL437-MA锁的款式；XX-MA锁安装面到拨叉末端的距离；\*-传动件扣手底部花纹；##-表面处理方式

材质：挤出型材

Name of product: MACRO Handle Lock

Artical No.: MAL437.XX\*.##

Description for artical number: MAL437-Style, 32-Install height  
\*-Figure, ##-Surface finish

Material: Profile Extrusion



蝴蝶锁的名称来源于该产品的对称安装，一个标准蝴蝶锁配一个锁座功能的假把手。蝴蝶锁是用于推拉门窗上的明装式五金，同时具有锁和拉手的功能，对型材结构要求相对较少，安装方便。该产品适用于大型推拉窗和推拉门。蝴蝶锁外形弧度柔和，操作手感舒适。根据实际需要，可选手动或自动模式；对于门框部位可以选择锁座配置，而双扇门窗还可以采用假把手配置，视觉效果对称平衡；随安全性要求不同，可以选择无锁芯或有锁芯的配置；室外可配置标准扣手或带锁芯扣手，需要与室内蝴蝶锁配套。型材结构的不同可能会影响蝴蝶锁的安装，产品选配时应咨询HOPO技术人员。

The name "Butter Fly Lock" comes from the shape when symmetrical solution of the lock (one standard handle and one handle as locking plate) installed on the central part of a 4-leafs sliding doors/windows. This surface-mounted lock has functions of lock and pull handle, with less requirement for groove of profiles. It is suitable for bing sliding doors and windows. The round curve of the lock provides comfortable feeling for operation. Solutions can be specified according to different requirements with manual or automatic functions, standard locking plate for frame mounting or locking plate handle for central part of double sliding leafs, with or without cylinder for the outside pull handle based on different security levels. The structure of profile could be of influence to the installation of the lock. Please consult HOPO technical department when necessary.

## 一、双扇配置/Double leaves specification

### 1、不带锁芯扇/Without cylinder leaf



名称 DESCRIPTION	编号 ARTICLE NO.	数量 Quantity
锁座 Locking plate	BH461. 60. **	1
手动把手(右) Manual handle (R)	BH461. 01. **R	1
扣手(无锁) Out pull (without cylinder)	BH461. 50. **	1

### 2、带锁芯扇/With cylinder leaf



名称 DESCRIPTION	编号 ARTICLE NO.	数量 Quantity
扣手(带锁) Out pull (with cylinder)	BH461. 51. **	1
手动带锁把手(左) Manual handle with cylinder(L)	BH461. 02. **L	1
锁座 Locking plate	BH461. 60. **	1

## 二、四扇推拉门配置方案/Sliding doors with four leaves specification solution

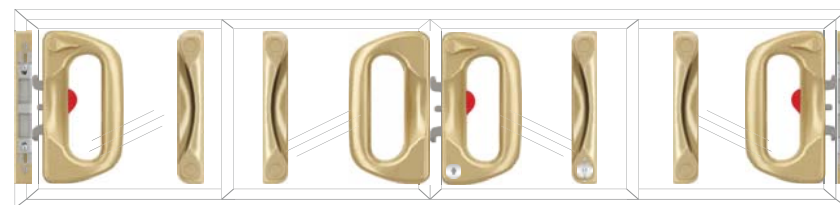

名称	编号	数量
手动把手(右) / Manual handle (R)	BH461. 01. **R	1
手动把手(左) / Manual handle (L)	BH461. 01. **L	1
扣手(无锁) / Out pull (without cylinder)	BH461. 50. **	3
锁座/Locking plate	BH461. 60. **	2
手动带锁把手(右) / Manual handle with cylinder (R)	BH461. 02. **L	1
扣手(带锁) / Out pull (with cylinder)	BH461. 51. **	1
假把手/False handle	BH461. 00. **	1

## 三、特别要求配置/Special Requirements specification

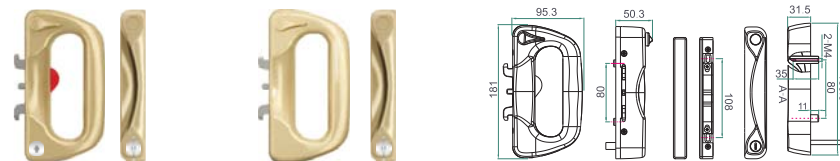

名称	编号	数量
手动室内带锁把手(右/左) / Manual inner handle with cylinder (R/L)	BH461. 03. **L/R	1
自动关闭带锁附件把手 / Self-closing handle	BH461. 12. **, L/R	1
自动关闭把手 / Self-closing handle with cylinder accessory	BH461. 11. **L/R	1
扣手(带锁) / Out pull (with cylinder)	BH461. 51. **	1

# HOPO

## PH900执手-正面的表现力

PH900 Handle Expressive power of the front



执手最常处于垂直位置，人从远处观看执手，正面的视觉表现力最强。PH900执手柄设计正是强化了执手垂直位置的正面的结构表现力。当代工业设计有一种强调立体感的趋势，PH900执手柄尾部的凹槽，给手柄增添了立体的装饰效果。顶部斜平面给人一种向上延伸的感觉，在中规中矩的力图实现空间的突破。手柄背面的钩型结构照顾到了开关窗时手的感受。

PH900执手的基座在内部结构方面的重要改进是底座改成了锌合金压铸件配优质弹簧，目的是避免注塑件基座寿命有限和承受力弱的缺点，提高产品的寿命和功能稳定性。该基座采用了全新的铝合金外套设计，一方面实现了基座与手柄统一的表面处理，另一方面突破了扣盖式基座对手柄形状的限制，为更丰富的手柄外形设计提供了可能性。

The most common position of a window handle is vertical, while man usually see the handle at the front area. Therefore, the vertical front view has the most expressive power of a handle, where the design of PH900 handle is emphasizing at. The contemporary industry design has a trend to form a perspective view for a flat area. The concave line surrounding the bottom part of the handle has an stereoscopic view effect, while the upper oblique face forms a feeling of upward stretching. To realize breaking-through in ordinary shape. The hook structure of the back of the handle make the hand's feeling comfortable.

The most important improvement of the new rose of PH900 is that the original PVC base has been changed into die-casting zinc alloy with high quality springs, to increase its life-time and function stability. The new rose has a structure of aluminum sleeve to realize unified surface treatment for both rose and hand shank, while the shape design of the hand shank has no restrict from the rose cover like other rose. The rose provides various possibility for handle design in the future.

# HOPO

## PH900执手-正面的表现力

PH900 Handle Expressive power of the front

PH900执手适用范围：推拉门、平开门、折叠门等

Application instructions of PH900 handle : Sliding doors, Side-hung doors, Slide-folding doors and so on.



产品名称：PH900执手

Name of product: 900 handle

产品编号：PH900. 40. 04

Artical number: PH900.40.04

编号说明：PH900-执手款式，40-方轴规格型号  
04-表面处理方式是氧化古铜色

Discription for artical number: PH900-Type, 40-Spindle length, 04-Surface finish: Anodized, Light bronze

材质：铝合金

Material: Aluminum

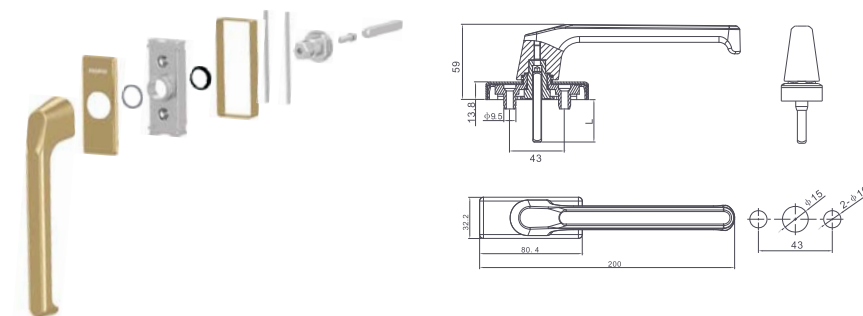

# HOPO

扁执手与剑的关系  
The relationship of handle and the sword



宝剑在冷兵器时代是兵器之王，冷峻而高傲。剑脊的直线是两侧剑锋向中部的汇合界面，是宝剑形象的灵魂。这款执手的设计灵感就是来源于对宝剑王者气势的崇拜。执手腰部弧线的过度，反衬出执手主体上剑脊直线的锋利感。剑脊的直线从这里一分为二，使剑体的刚毅与剑柄的柔和浑然天成。

In the era of cold weapon, sword is the king of all weapons, cold and proud. The line of centralized sword ridge is right and straight, not as fierce and brutal as the two side blades, but guiding the blades to the most powerful end point, concentrated and sharp. It forms the soul of the sword. The idea of the design for the handle comes rightly from the worship to the ancient nobility of power. When the centralized ridge line divides into two lines in the mellow and slim middle part of the handle, it changes the feeling of power into gentleness and friendship. It takes care of feeling of the hand of humankind.

# HOPO

扁执手与剑的关系  
The relationship of handle and the sword



HOPO扁执手适用范围：用于折叠系统。  
Application instruction: Applicable to Slide & Fold door fittings

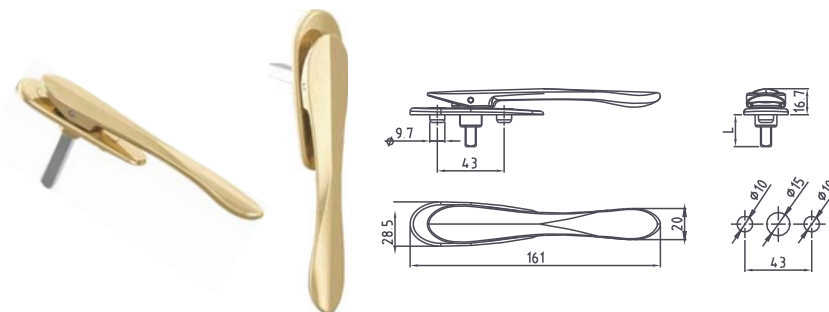

产品名称：扁执手

产品编号：PH172. 40. 028

编号说明：PH172-执手的款式；40-方轴的规格型号；028-表面处理方式是电镀珍珠铬

材质：锌合金

Name of product: Short neck handle

Artical number: PH172.40.028

Discription for artical number: PH172-Type, 40-Spindle length, 028-Surface finish: galvanized with pearl chrome

Material: Zinc alloy

### 方案一/Specification 1

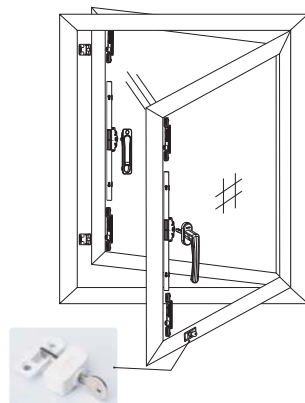
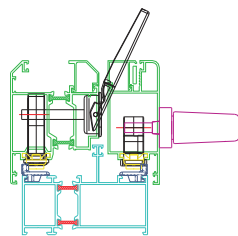

产品名称：隐藏执手  
产品编号：PH400. 20. 09  
编号描述：PH400-隐藏执手：20-轴长20mm(可选15/25/30/40)  
09-亚黑色, 01-银色, 07-白色  
材质说明：锌合金，表面颜色经过喷涂处理  
适用范围：主要用于推拉内部联动配置

Name of product: Concealed handle  
Article No: PH400.20.09  
Description of article number: PH400-style; 20-spindle length 20mm (15/25/30/40 can be chose); 07- white, 09- black, 01-silver  
Material: Zinc alloy material, spraying colorful paint surface.  
Application instructions: mainly used for slide fittings inline.

### 方案二/Specification 2

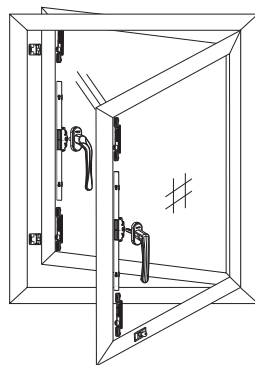
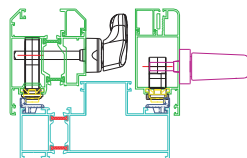

产品名称：PH103执手  
产品编号：PH103. 00. 011R  
编号说明：PH-塑钢执手, 103-系列扁执手, 00-无轴  
011-氧化银, R-右(此手柄有左右之分)  
材质说明：硬质氧化铝，表面氧化处理  
实用范围：用于双层窗上

Name of product: PH103 handle  
Article No: PH103.00.011R  
Description of article number: PH—PVC handle, 103—short neck handle;  
00—without spindle ; 011— anodizing silver, R—right  
Material: Hard alumina, Surface oxidation treatment  
Application instructions: used for double layer window.

### 方案三/Specification 3

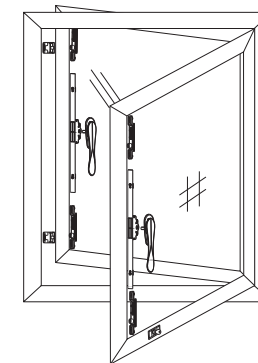
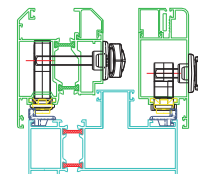

产品名称：PH173扁执手  
产品编号：PH173. 30. 04  
编号描述：PH173-扁执手款式, 30-万轴长度可定制  
043-喷涂古铜 012-喷涂银色 069-亚黑 07-白色  
材质说明：锌合金材质，表面氧化处理  
适用范围：用于折叠门系统上，万轴长度根据客户要求定制。

Name of product: PH173 short neck handle  
Article No: PH173.30.04  
Description of article number: PH173-PVC handle; 30-spindle length 30mm (it can be made to order); 043-bronze, 012-silver, 069-black, 07-white  
Material: zinc alloy, surface oxidation treatment  
Application instructions: used for double layer window.

### 方案四/Specification 4

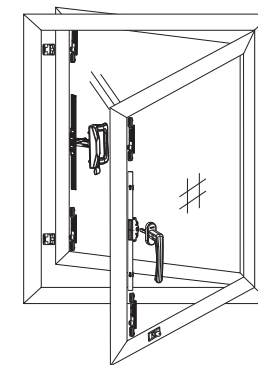
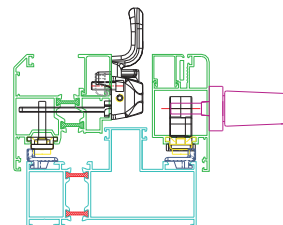

产品名称：AH401执手  
产品编号：AH401. 50. 043  
编号描述：AH401-型号, 50-拨叉长度50mm  
043-喷涂古铜 012-喷涂银色 069-亚黑 07-白色  
材质说明：锌合金，表面颜色喷涂处理  
应用说明：用于双层窗上。

Name of product: AH401 handle  
Article No: AH401.50.043  
Description of article number: AH401-style; 50-carrier fork length 50mm  
043-bronze, 012-silver, 069-black, 07-white  
Material: zinc alloy, surface spraying treatment  
Application instructions: used for double layer window.